



Over-Center[™] Hydraulic Steel Lift

24,000 lbs Capacity Model # 24k60

- ASSEMBLY
- INSTALLATION
- REPLACEMENT PARTS

**READ complete manual CAREFULLY
BEFORE attempting assembly or operation**

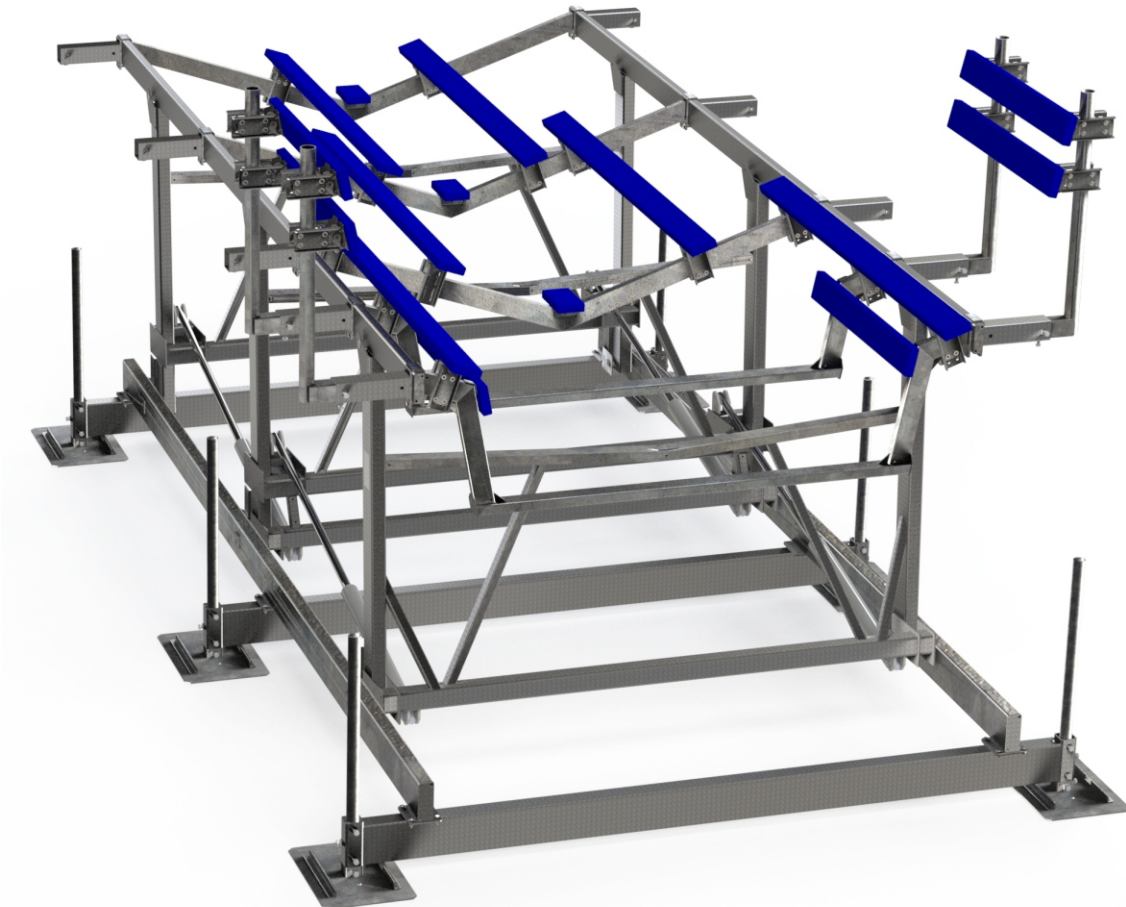

866-GO-BASTA
www.gobasta.com

INDEX

Warning	Page 2
Parts Assembly Diagram	Page 3
Assembly Instructions	Pages 4 - 12
First Use / Adjustments	Page 13
Basta Marine Boat Lift Accessories	Page 16
Troubleshooting / FAQ	Page 14
Warranty	Page 15



WARNING

NOTE: Your boat lift is a very heavy piece of equipment. Improper use could result in serious injury or death. For the safety of people and property please review the safety guidelines below for your new boat lift.

MAXIMUM CAPACITY
24,000 LBS
10,800 KG

⚠ DANGER

Do not exceed the maximum weight capacity specified for the lift. SEE PAGE 18.

- Visually inspect all parts and assemblies for defects and damage prior to assembling the lift.
- Do not install the lift alone.
- Install the lift on firm and level ground.
- Verify the lower frame of the lift is level before each use.
- Turn the power off during periods of non- use.

- This hoist is a heavy piece of equipment please use with care.
- The lift should not be used for any other purpose besides the lifting of boats & watercraft.
- Passengers should stand clear of the lift and not be aboard when the lift is in operation.
- Do not play on or near the lift.
- Leave your automatic bilge pump turned on the automatic setting to prevent the accumulation of rain water.
- Service your lift regularly.
- Do not service the unit with the boat on the lift.
- Use a mooring line for additional security.
- Only use Basta Marine approved oil in lift. Special biodegradable non-toxic hydraulic fluid part # **Y354-0001**

For a full list of patents, go to:
bastaboatlifts.com/patents





Before Using:

Read this manual completely!



INSPECT

the lift monthly

for frayed hoses, loose fasteners and corrosion

DO NOT

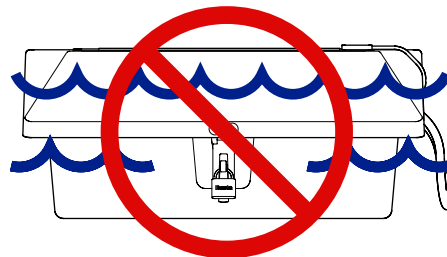

SUBMERGE POWER UNIT

⚠ DANGER

Avoid all moving parts to prevent death or serious injury



STAY CLEAR!

Exceeding lift capacity may result in structural failure, injury or death

⚠ WARNING



Do not use to lift humans

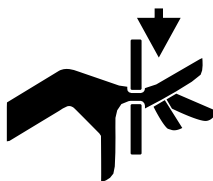

Power unit lid may close suddenly

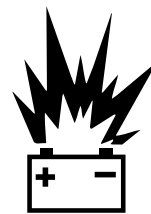

Battery produces flammable hydrogen

Failure to properly position boat on lift could cause lift to become unstable

Always raise lift fully upright Over-Center ^(TM) if boat is on lift unattended

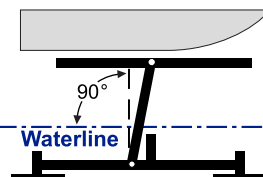

Waterline

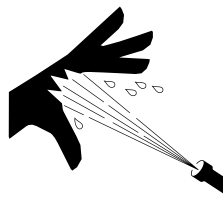

High pressure hydraulics can penetrate skin

OIL INJECTED INTO THE SKIN FROM HIGH PRESSURE LEAKS IN HYDRAULIC SYSTEMS CAN CAUSE SEVERE INJURY. MOST DAMAGE OCCURS DURING THE FIRST FEW HOURS. SEEK MEDICAL ATTENTION IMMEDIATELY. SURGICAL REMOVAL OF OIL MAY BE NECESSARY.

Before use always check that lift frame is level



Waterline

USE ONLY BASTA BIODEGRADABLE HYDRAULIC FLUID

⚠ WARNING

After the lift is assembled and installed, all fasteners should be checked for proper tightness and reinspected periodically.

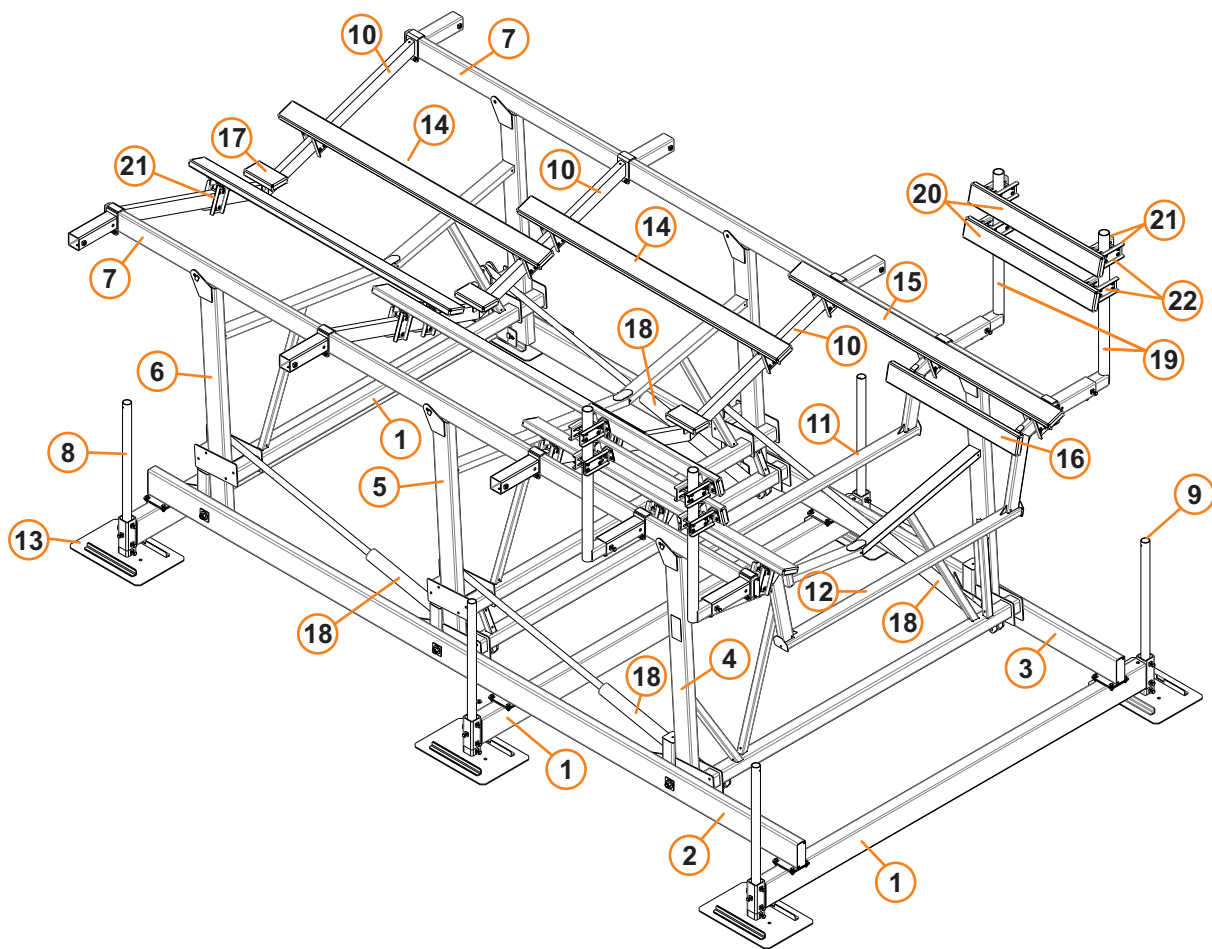

MODEL 24k60

ITEM	PART #	DESCRIPTION	QTY
1	W110-0026	Base Crossmember	3
2	W104-0024	Left Side Rail	1
3	W104-0025	Right Side Rail	1
4	W101-0049	H-Frame, Aft	1
5	W101-0048	H-Frame, Center	1
6	W101-0047	H-Frame, Forward	1
7	W113-0022	Bunk Rail	2
8	K200-0012	Adjustable Support Leg	6
9	F730-0013	Leg Cap	6
10	W113-0029	Bunk Chevron, Forward	3
11	W113-0031	Bunk Chevron, Mid	1
12	W113-0030	Bunk Chevron, Aft	1
13	W116-0003	Foot Pad	6
14	A428-0029	Bunk Board Assembly, Forward	4
15	A428-0030	Bunk Board Assembly, Aft	2
16	W410-0070	Guide Board	2
17	W410-0081	Keel Block	3
18	CALL	Dual Hydraulic Cylinder Kit	2
19	W108-0046	Load Guide/CD Stanchion	2+
20	A481-1002	Guide Board Assembly, Upper	4
21	K204-0116	Bunk Stanchion	44
22	K204-0160	Bunk Stanchion Backing Plate	44

*Centering Devices not pictured

In the following pages various symbols are used:

- 1 indicates an illustration for a procedure.
- 12 indicates a major part shown and described above.
- C3 indicates a hardware item shown and described on page 5.

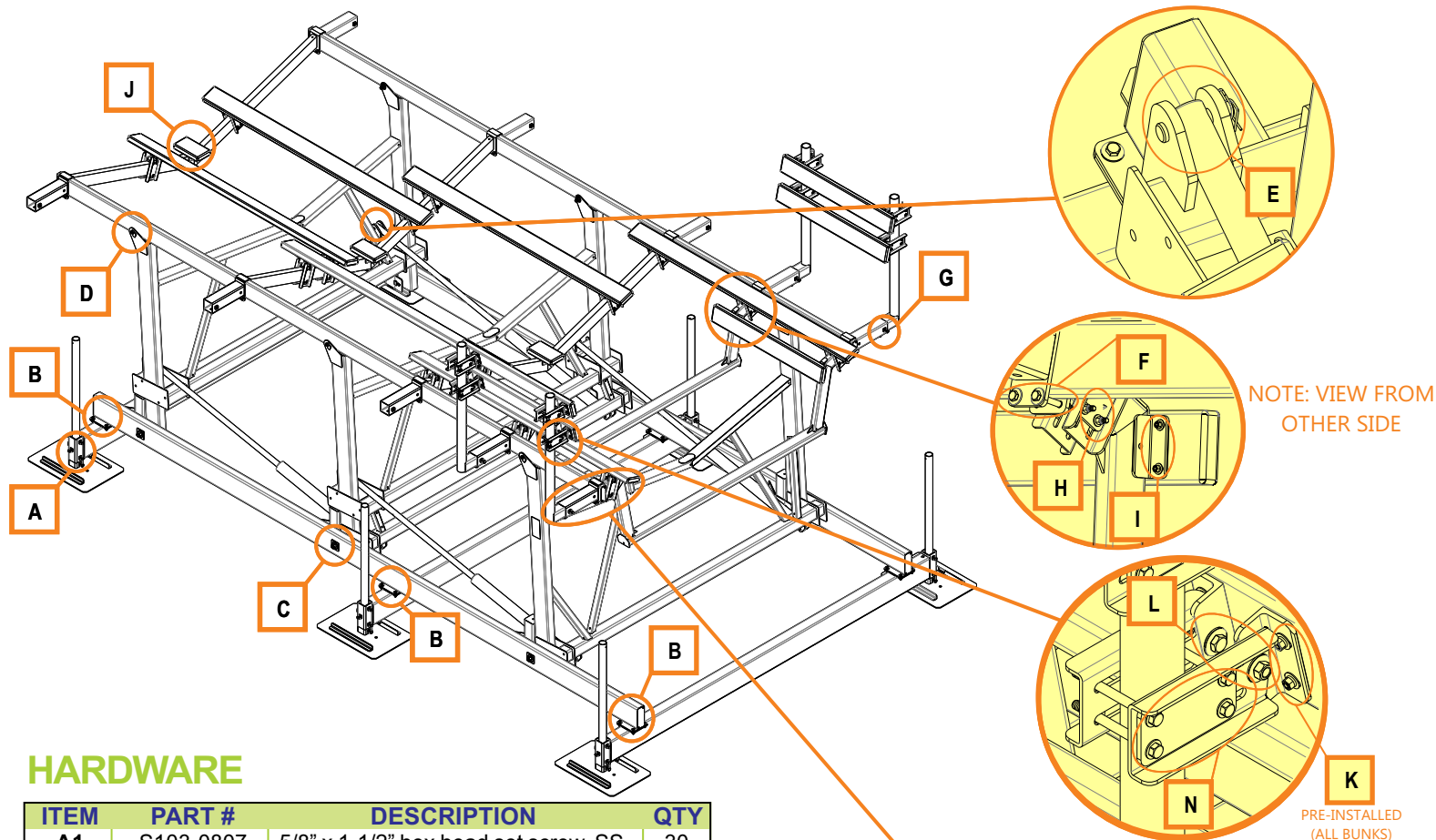

HARDWARE

ITEM	PART #	DESCRIPTION	QTY
A1	S103-0807	5/8" x 1-1/2" hex head set screw, SS	30
B1	S103-0707	1/2" x 1-1/2" hex head cap screw, SS	24
B2	S313-0010	1/2" flat washer, SS	48
B3	S362-0010	1/2" nylon insert lock nut, SS	24
C1	S103-1020	1" x 9" hex head cap screw, SS	6
C2	S313-4015	1" flat washer, SS	6
C3	S362-0014	1" nylon insert lock nut, SS	6
D1	S103-0912	3/4" x 5" hex head cap screw, SS	6
D2	S313-0013	3/4" flat washer, SS	6
D3	S362-0012	3/4" nylon insert lock nut, SS	6
E1	S522-0801	ring type cotter pin, SS	8
E2	S503-0013	3/4" x 3-1/2" clevis pin, SS	8
F1	S103-0717	1/2" x 4" hex head cap screw, SS	20
F2	S313-0010	1/2" flat washer, SS	40
F3	S362-0010	1/2" nylon insert lock nut, SS	20
G1	S103-0707	1/2" x 1-1/2" hex head cap screw, SS	28
G2	S313-0010	1/2" flat washer, SS	56
G3	S362-0010	1/2" nylon insert lock nut, SS	28
H1	S103-0717	1/2" x 4" hex head cap screw, SS	56
H2	S313-0010	1/2" flat washer, SS	112
H3	S362-0010	1/2" nylon insert lock nut, SS	56
I1	S312-0007	5/16" flat washer, galvanized	8
I2	S321-0007	5/16" lock washer, galvanized	8
I3	S341-0007	5/16" hex nut, galvanized	8
J1	S312-0007	5/16" flat washer, galvanized	12
J2	S321-0007	5/16" lock washer, galvanized	12
J3	S341-0007	5/16" hex nut, galvanized	12
K1	S312-0007	5/16" flat washer, galvanized	88
K2	S321-0007	5/16" lock washer, galvanized	88
K3	S341-0007	5/16" hex nut, galvanized	88
L1	S103-0707	1/2" x 1-1/2" hex head cap screw, SS	8
L2	S313-0010	1/2" flat washer, SS	16
L3	S362-0010	1/2" nylon insert lock nut, SS	4
M1	S103-0807	5/8" x 1-1/2" hex head set screw, SS	16
N1	S103-0719	1/2" x 5" hex head cap screw, SS	32
N2	S313-0010	1/2" flat washer, SS	64
N3	S362-0010	1/2" nylon insert lock nut, SS	32

*Centering device (CD) hardware not pictured

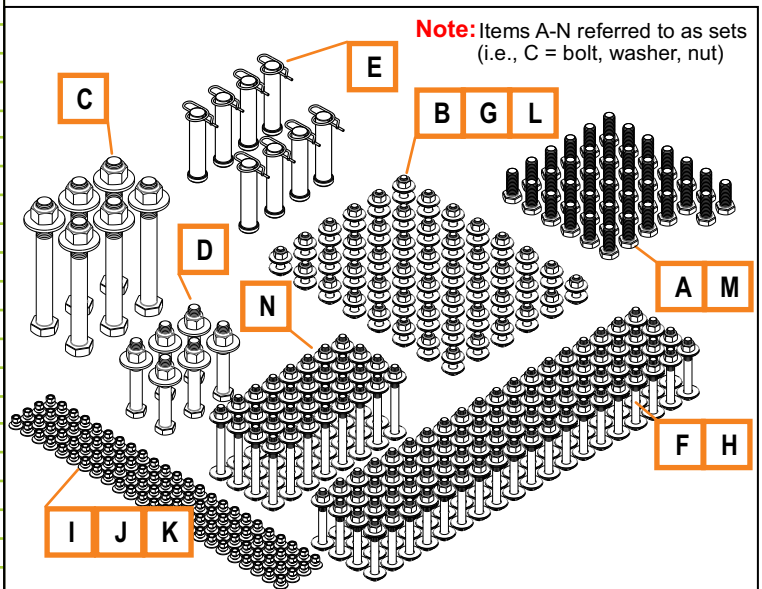

ASSEMBLY INSTRUCTIONS

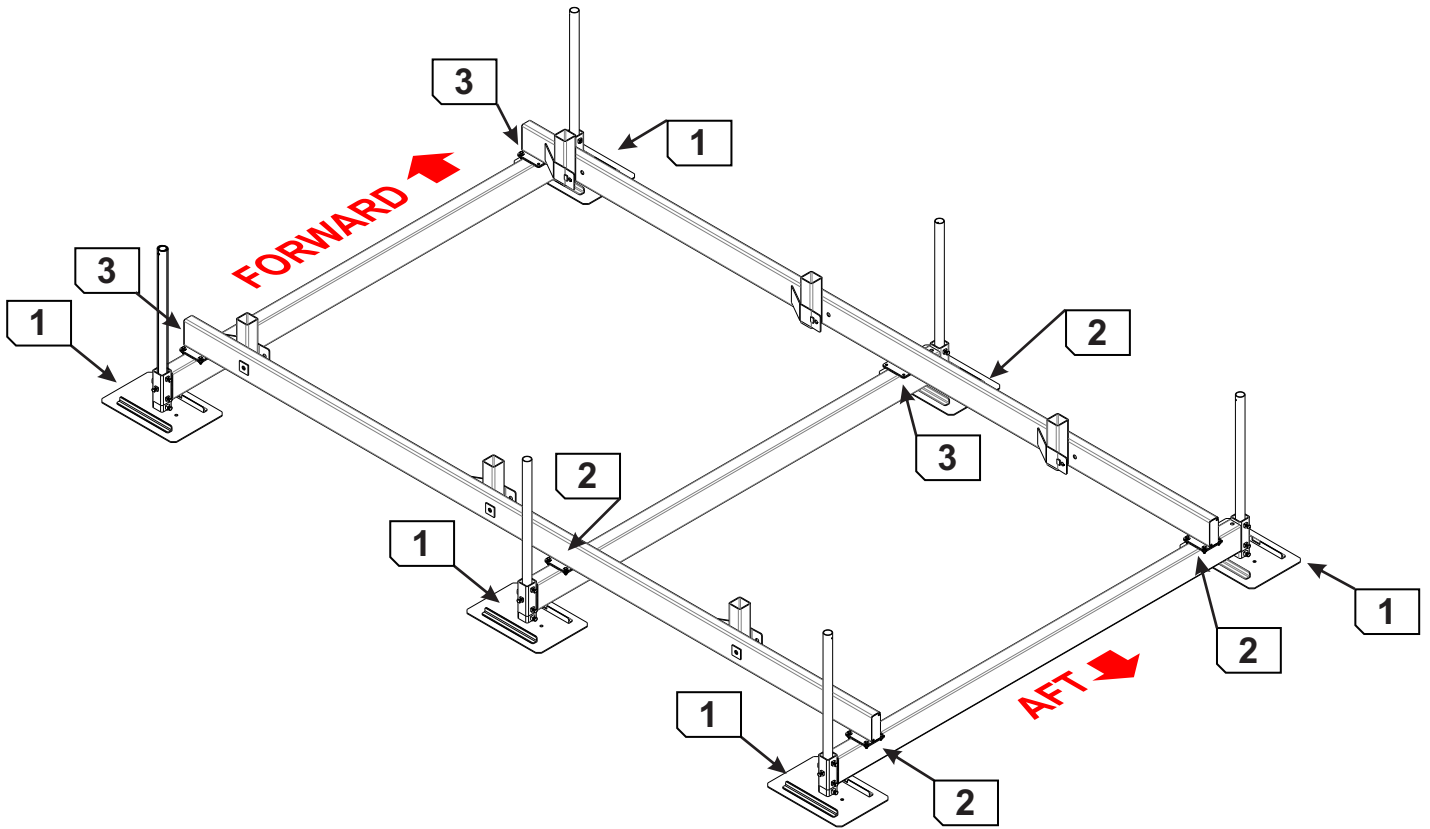

**tighten leg set screws
alternately to push the
leg securely into the
corner of the leg socket**



step

1

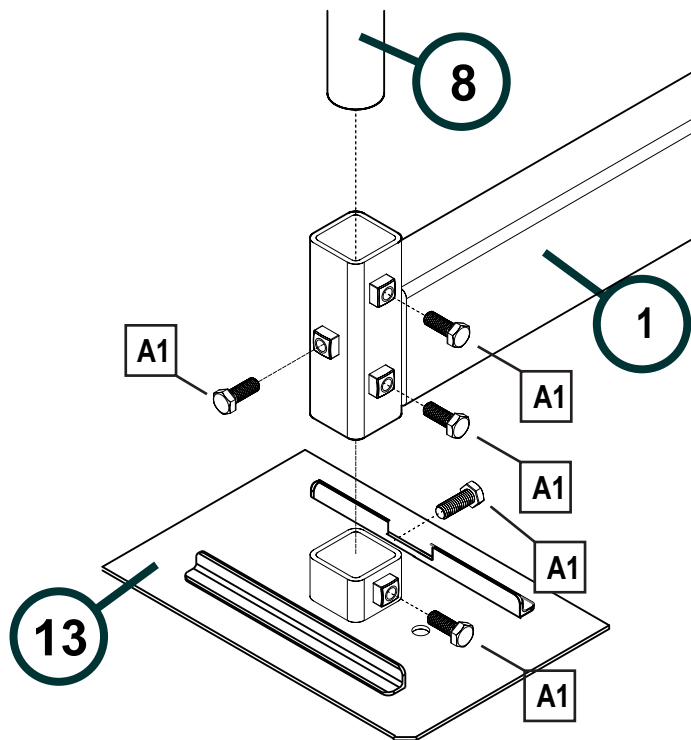

QTY		SIZE	TYPE	REF
30		5/8 x 1-1/2	hex head set screws	A1

HARDWARE

apply a small amount of grease to bolt threads

HARDWARE
apply a small
amount of grease
to bolt threads

? parts identified on page 4

Aft & Center Crossmembers

step
2

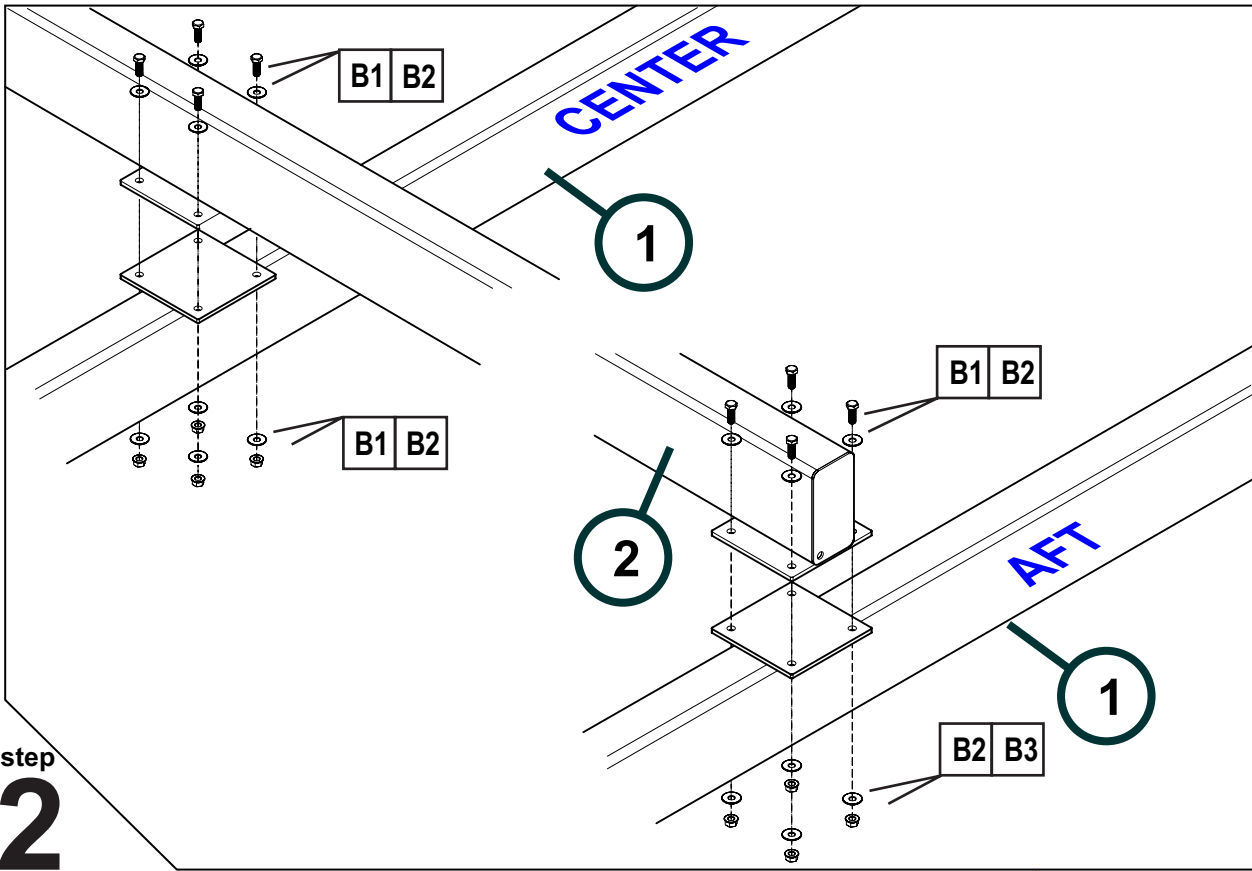

QTY	SIZE	TYPE	REF
16	3/8 x 1-1/4	bolts	B1
32	3/8	flat washers	B3
16	3/8	lock nuts	B2

HARDWARE
apply a small amount of grease to bolt threads

? parts identified on page 4

do not tighten these bolts completely until the H-frames and bunks have been installed & squared up

do not tighten these bolts completely until the H-frames and bunks have been installed & squared up

Forward Crossmember

3

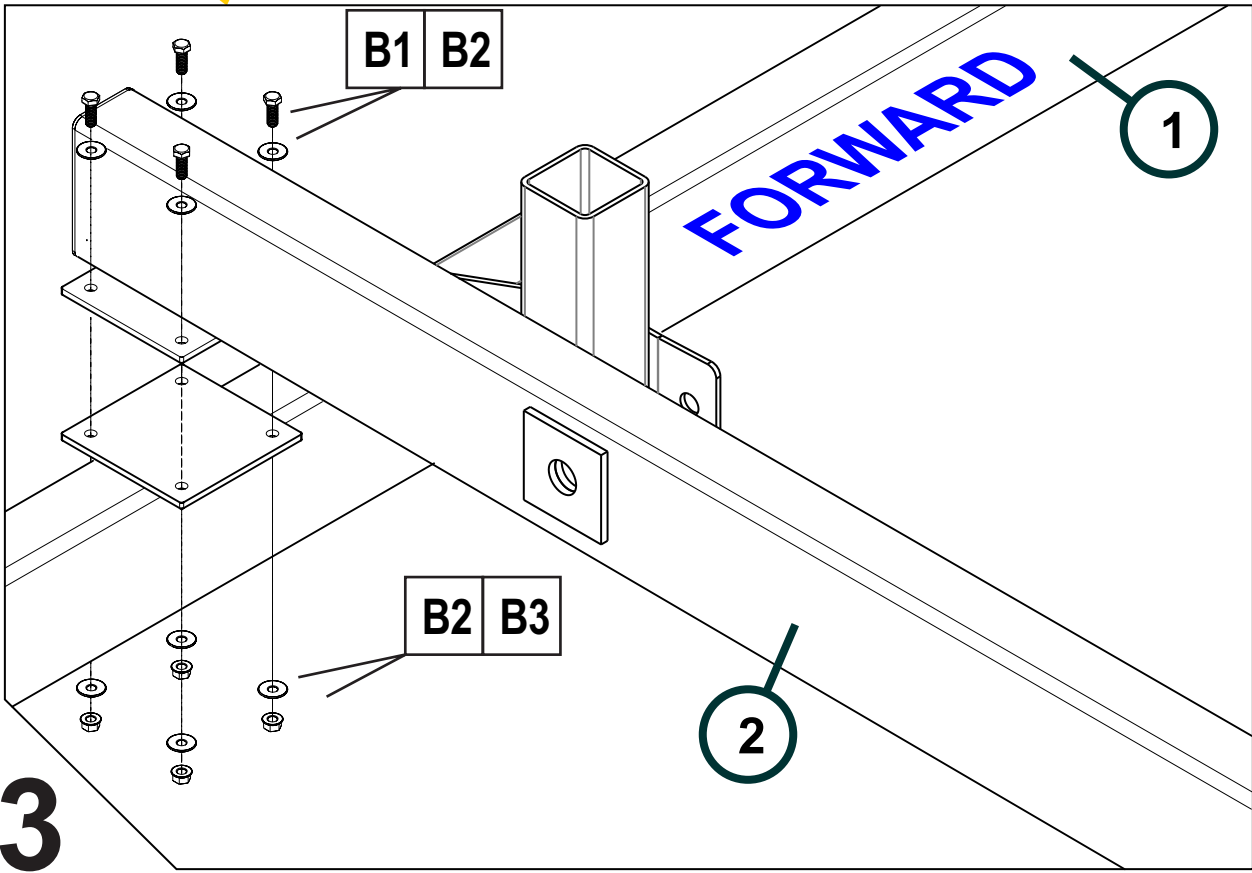

QTY	SIZE	TYPE	REF
8	3/8 x 1-1/4	bolts	B1
16	3/8	flat washers	B3
8	3/8	lock nuts	B2

HARDWARE
apply a small amount of grease to bolt threads

? parts identified on page 4

ASSEMBLY INSTRUCTIONS

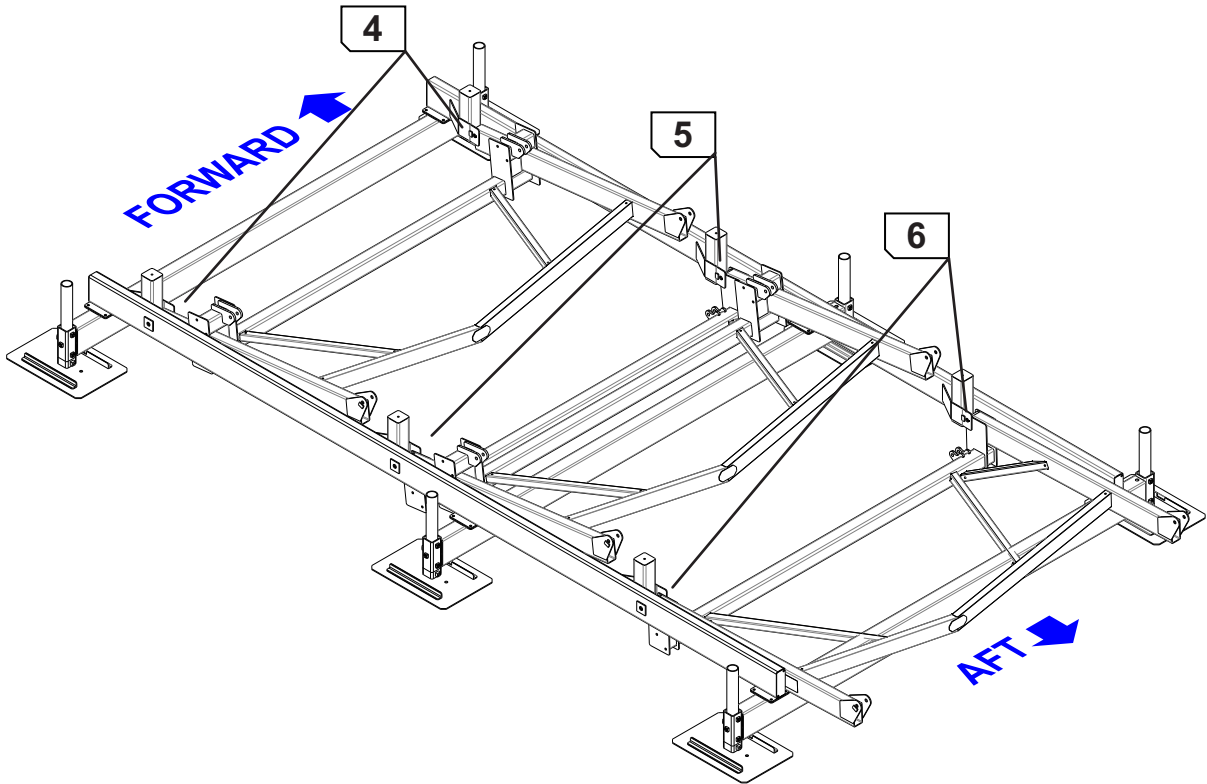

Forward H-Frame

step
4

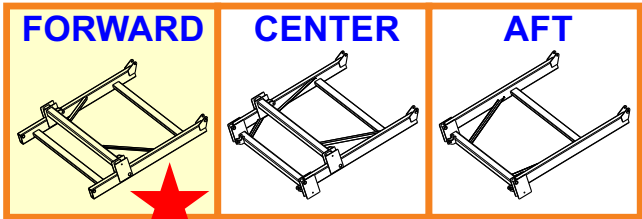
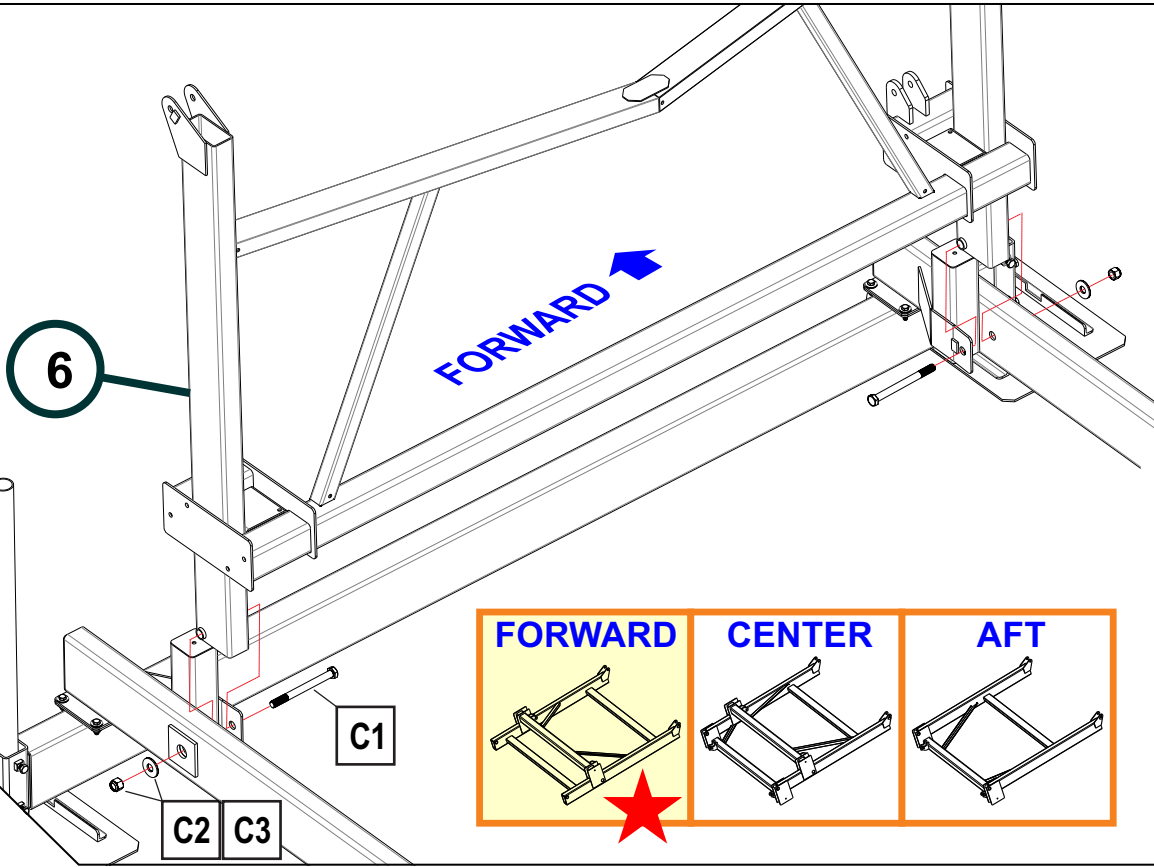

QTY	SIZE	TYPE	REF
2	1 x 9	bolts	C1
2	1	flat washers	C2
2	1	lock nuts	C3

HARDWARE
apply a small amount of grease to bolt threads

Center H-Frame

step
5

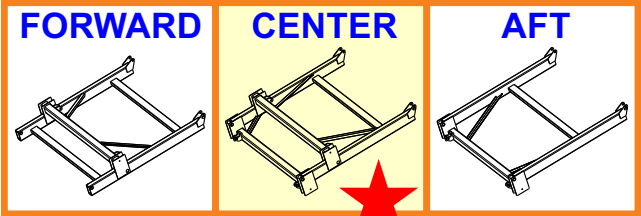
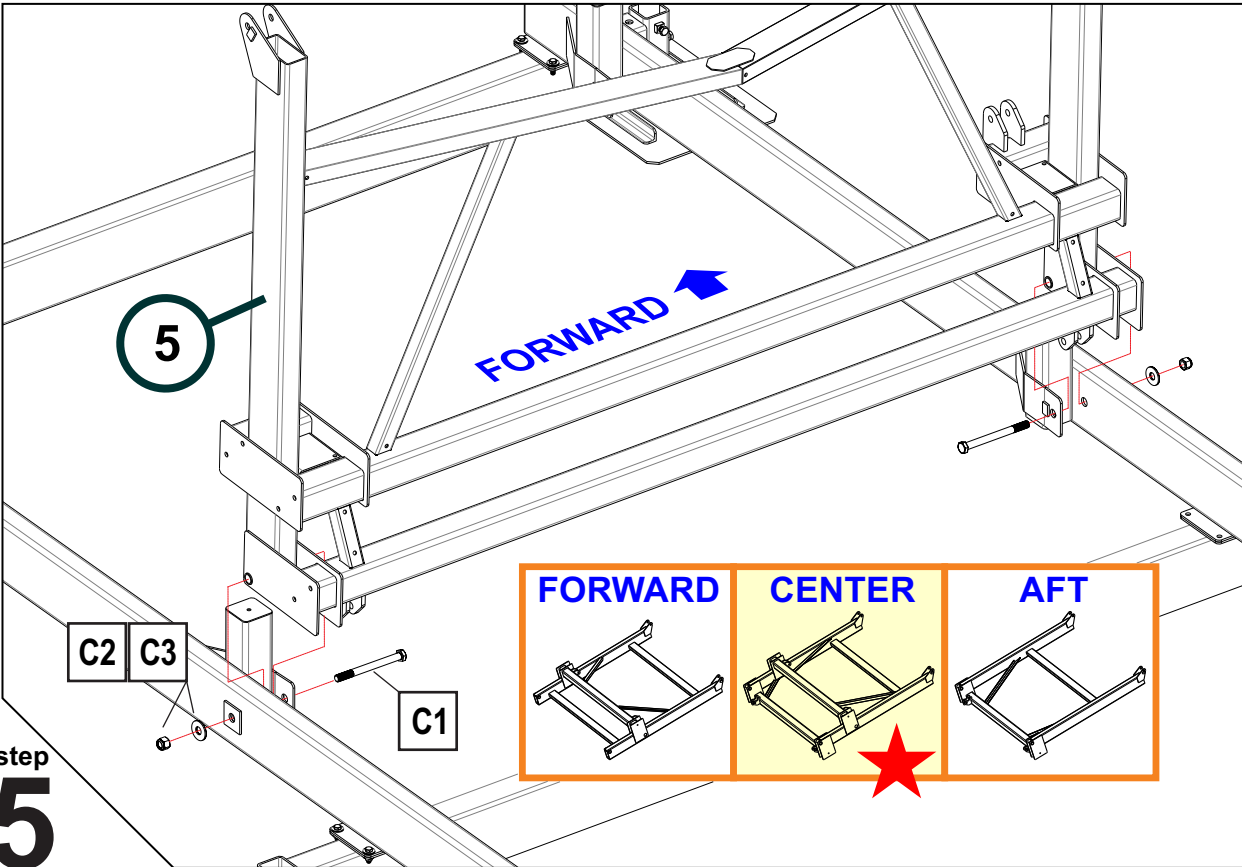

QTY	SIZE	TYPE	REF
2	1 x 9	bolts	C1
2	1	flat washers	C2
2	1	lock nuts	C3

HARDWARE
apply a small amount of grease to bolt threads

? parts identified on page 4

Aft H-Frame

step
6

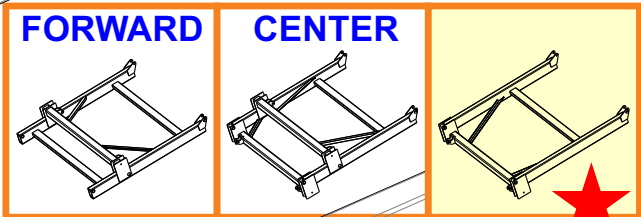
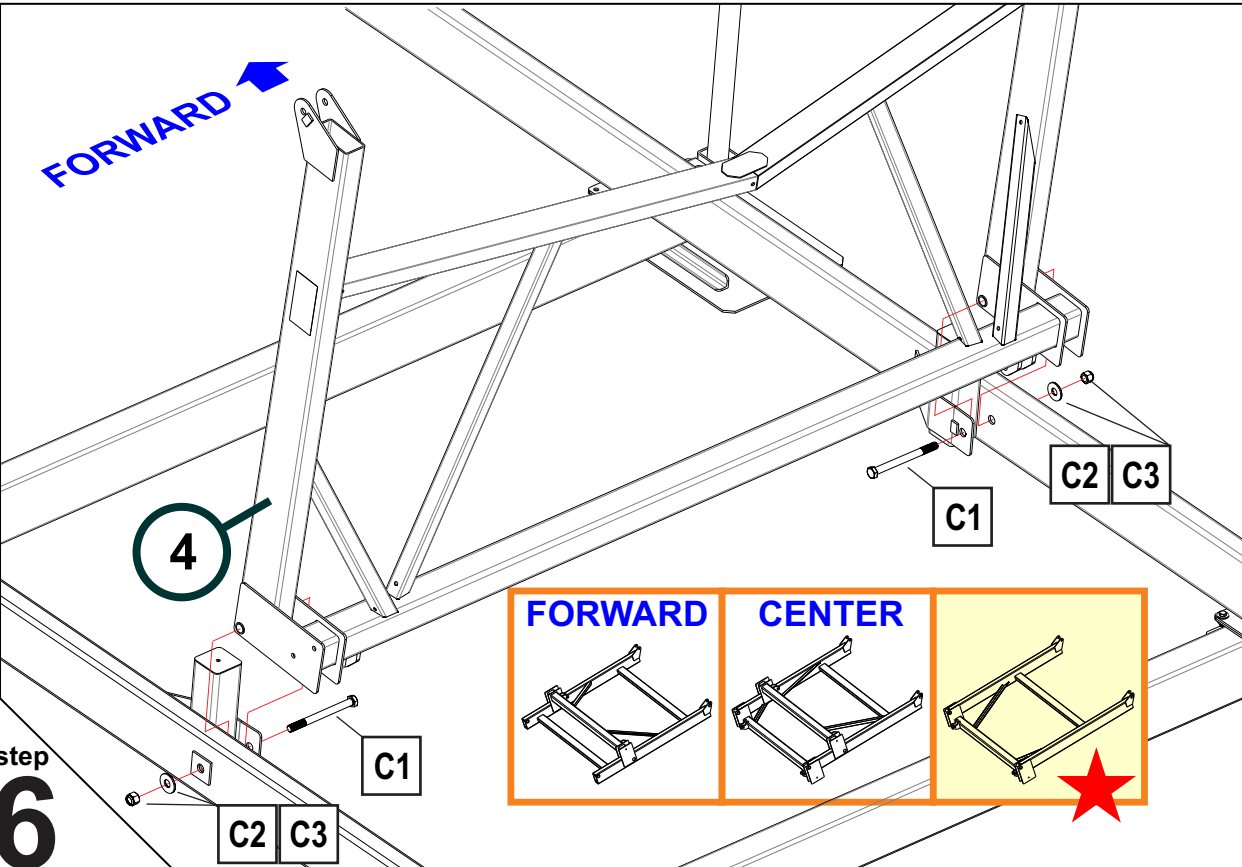

QTY	SIZE	TYPE	REF
2	1 x 9	bolts	C1
2	1	flat washers	C2
2	1	lock nuts	C3

HARDWARE
apply a small amount of grease to bolt threads

? parts identified on page 4

ASSEMBLY INSTRUCTIONS

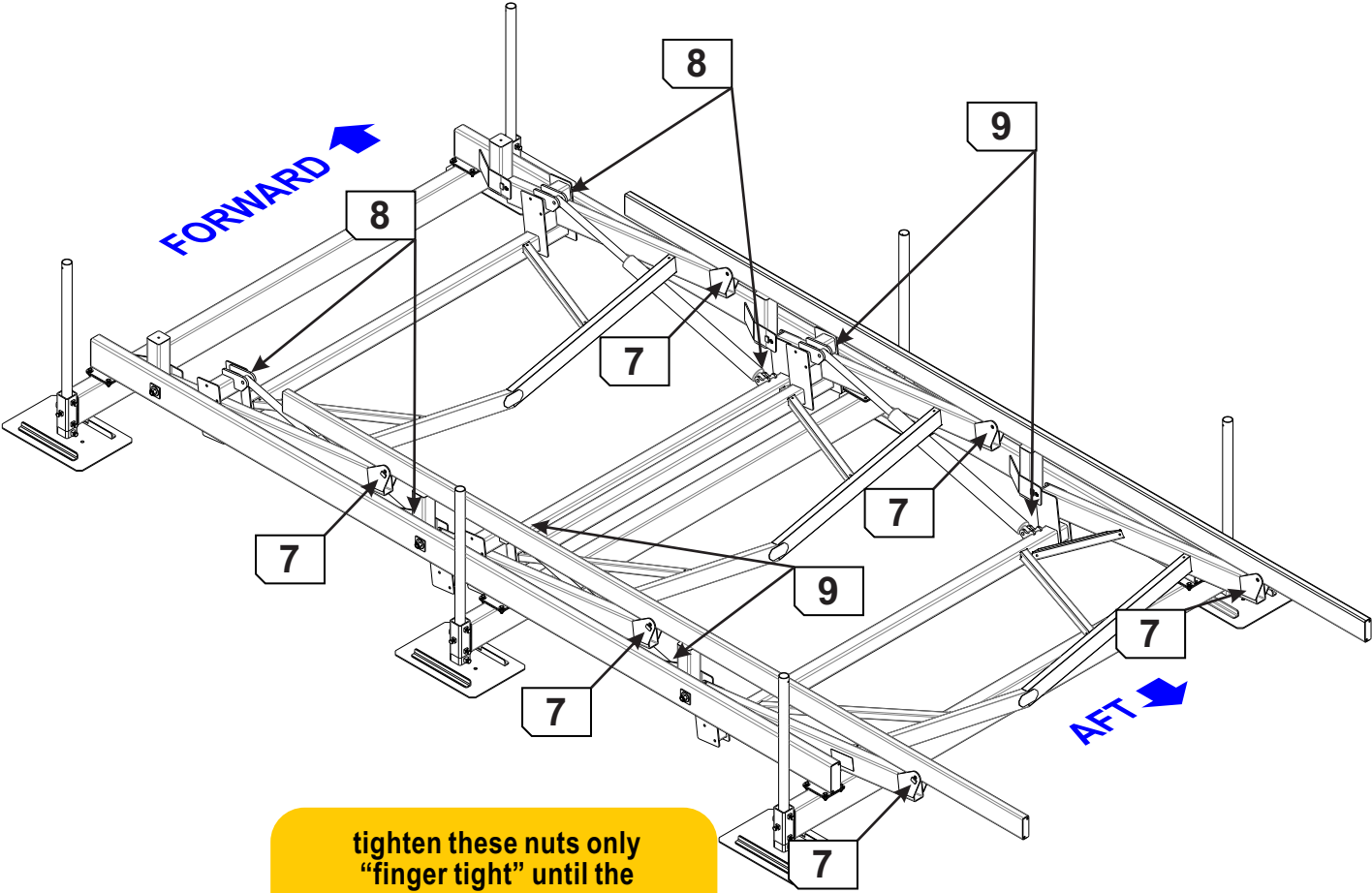

Bunk Rails

step
7

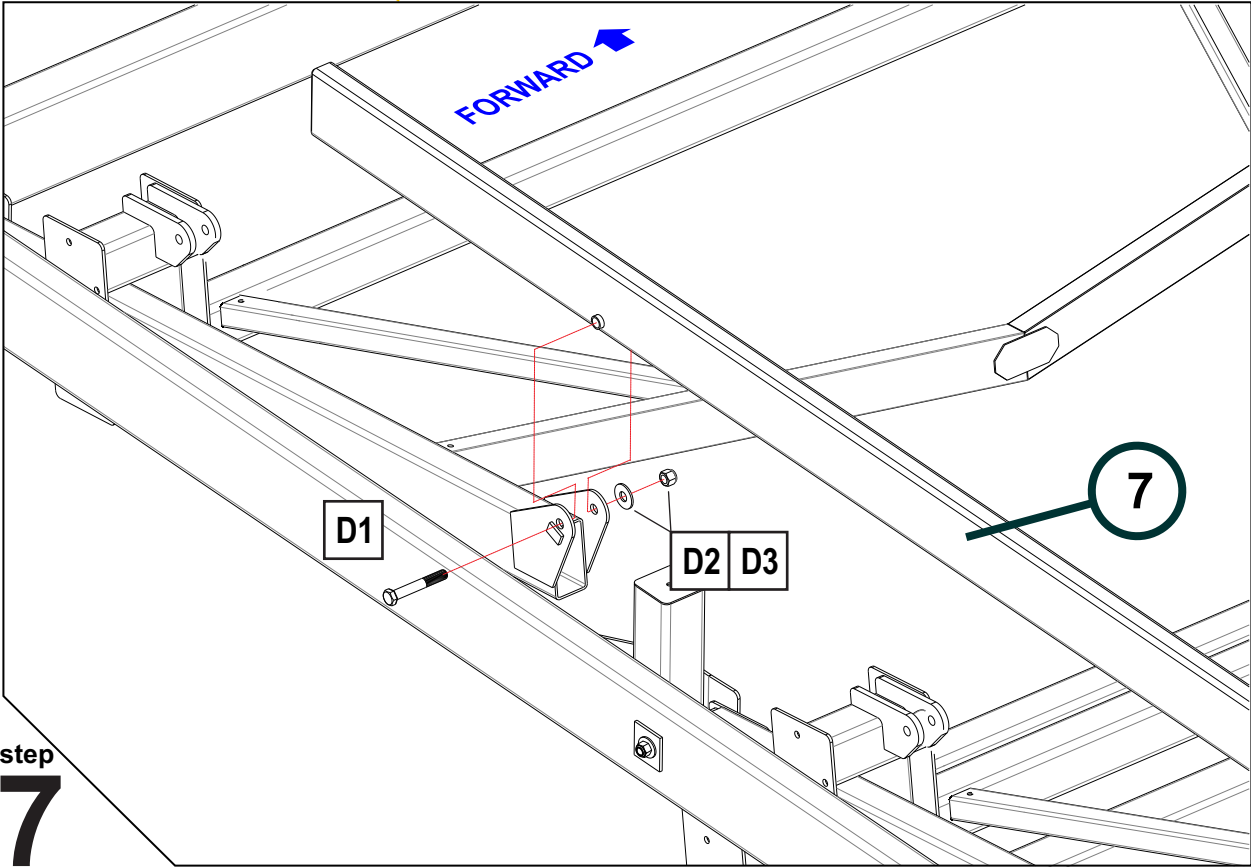

QTY	SIZE	TYPE	REF
6	3/4 x 5	bolts	D1
6	3/4	flat washers	D2
6	3/4	lock nuts	D3

HARDWARE
apply a small amount of grease to bolt threads

Forward Hydraulic Cylinders

NOTE: Install cylinder with lift in 'down' position

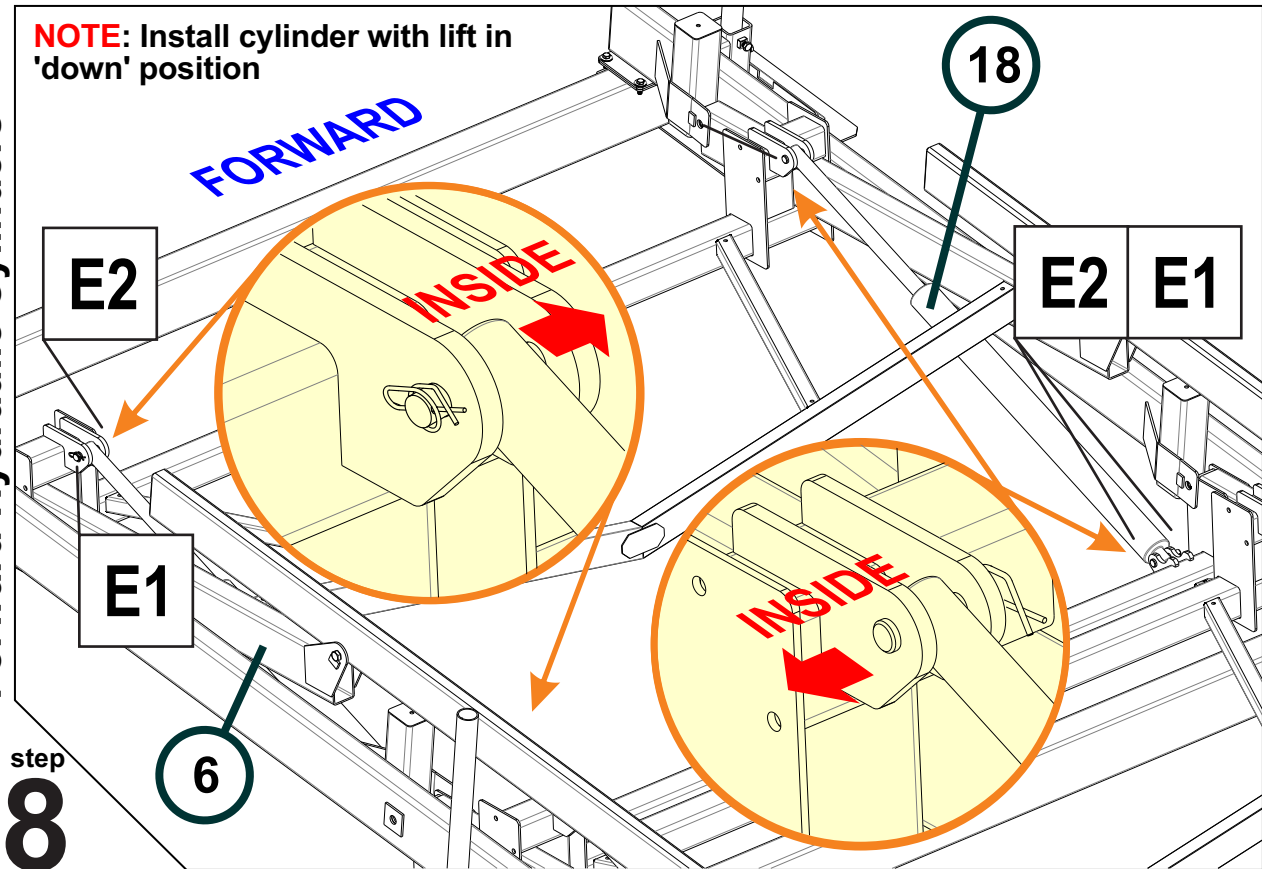

QTY	SIZE	TYPE	REF
4	3/32 x 2	ring type cotter pins	E1
4	3/4 X 5	clevis pins	E2
HARDWARE			

NOTICE
tighten the bunk rail nuts and crossmember bolts after all the cylinders are installed

install the clevis pins "E2" with their heads toward the inside of the lift

parts identified on page 4

Aft Hydraulic Cylinders

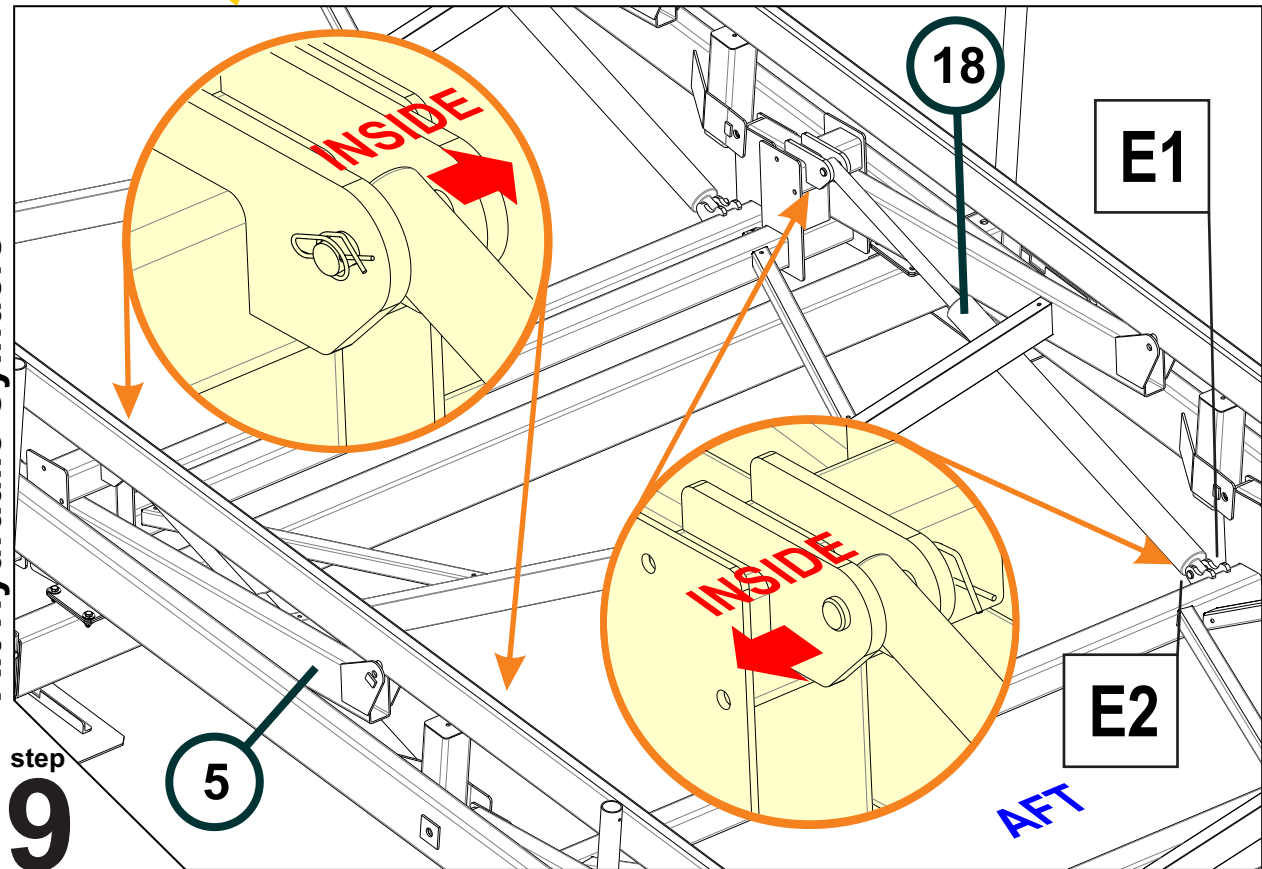

QTY	SIZE	TYPE	REF
4	3/32 x 2	ring type cotter pins	E1
4	3/4 X 5	clevis pins	E2
HARDWARE			

parts identified on page 4

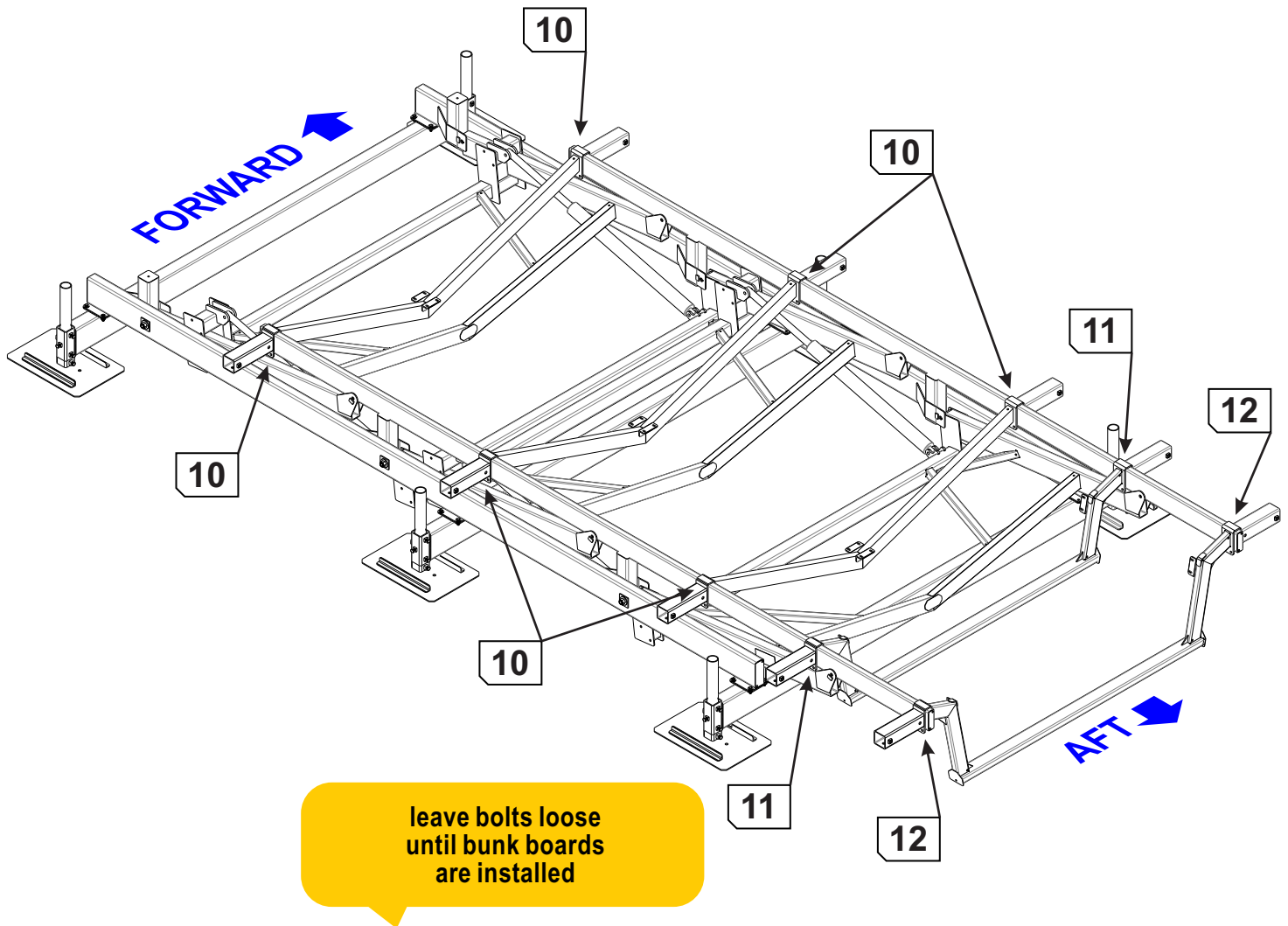

Bunk Chevrans FWD (3 total)

Diagram showing the installation of bunk chevrons. Dimensions for approximate starting locations are provided: 198cm (78"), 198cm (78"), 94cm (37"), and 104cm (41"). Hardware callouts include F1, F2, F3, and 10. A circular inset shows a detail of the chevron with dimensions 2.54cm (1").

QTY	SIZE	TYPE	REF
12	1/2 x 4	bolts	F1
24	1/2	flat washers	F2
12	1/2	lock nuts	F3

step 10

HARDWARE
apply a small amount of grease to bolt threads

Bunk Chevrans MID-AFT

step
11

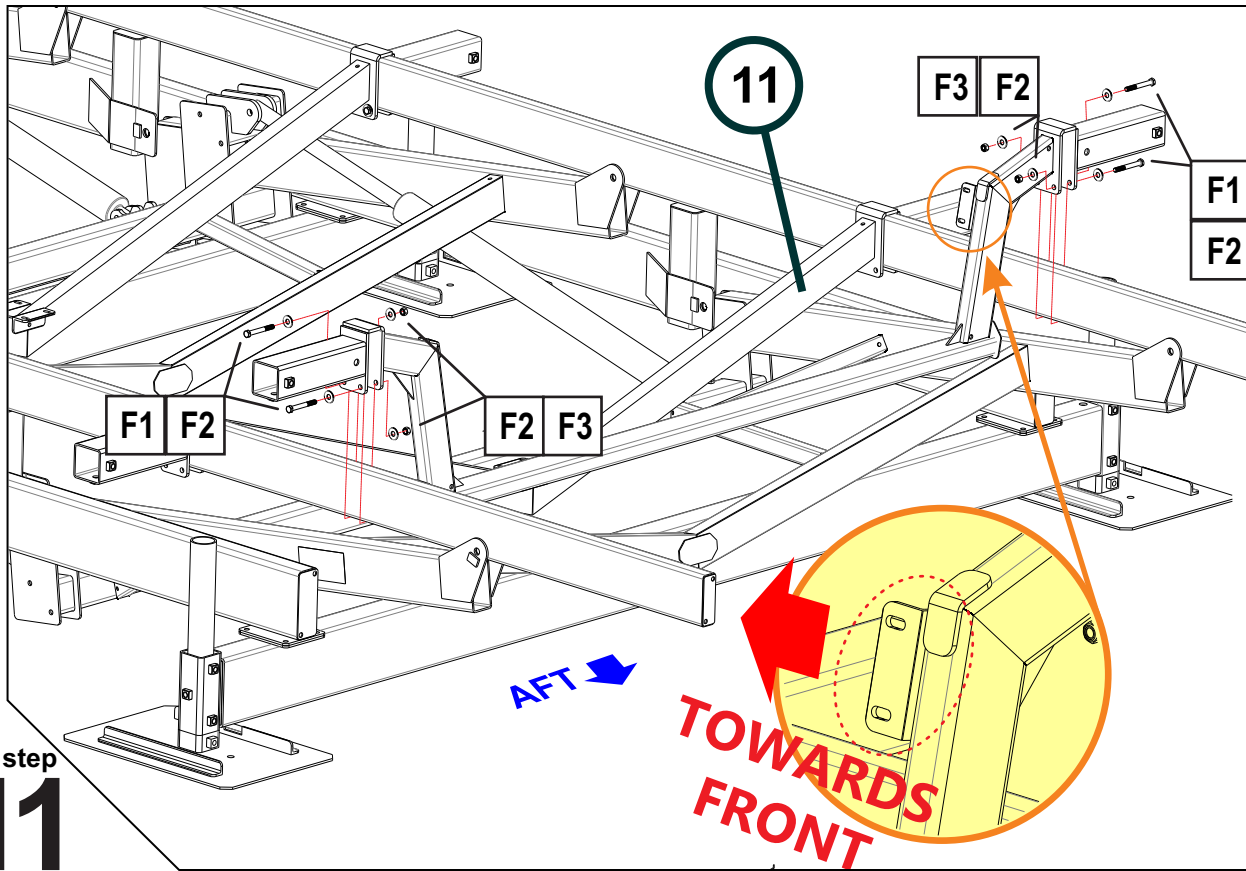

REF	TYPE	SIZE	QTY	HARDWARE
F1	bolts	1/2 x 4	4	apply a small amount of grease to bolt threads
F2	flat washers	1/2	8	
F3	lock nuts	1/2	4	

? parts identified on page 4

leave bolts loose until bunk boards are installed

leave bolts loose until bunk boards are installed

Bunk Chevrans AFT

step
12

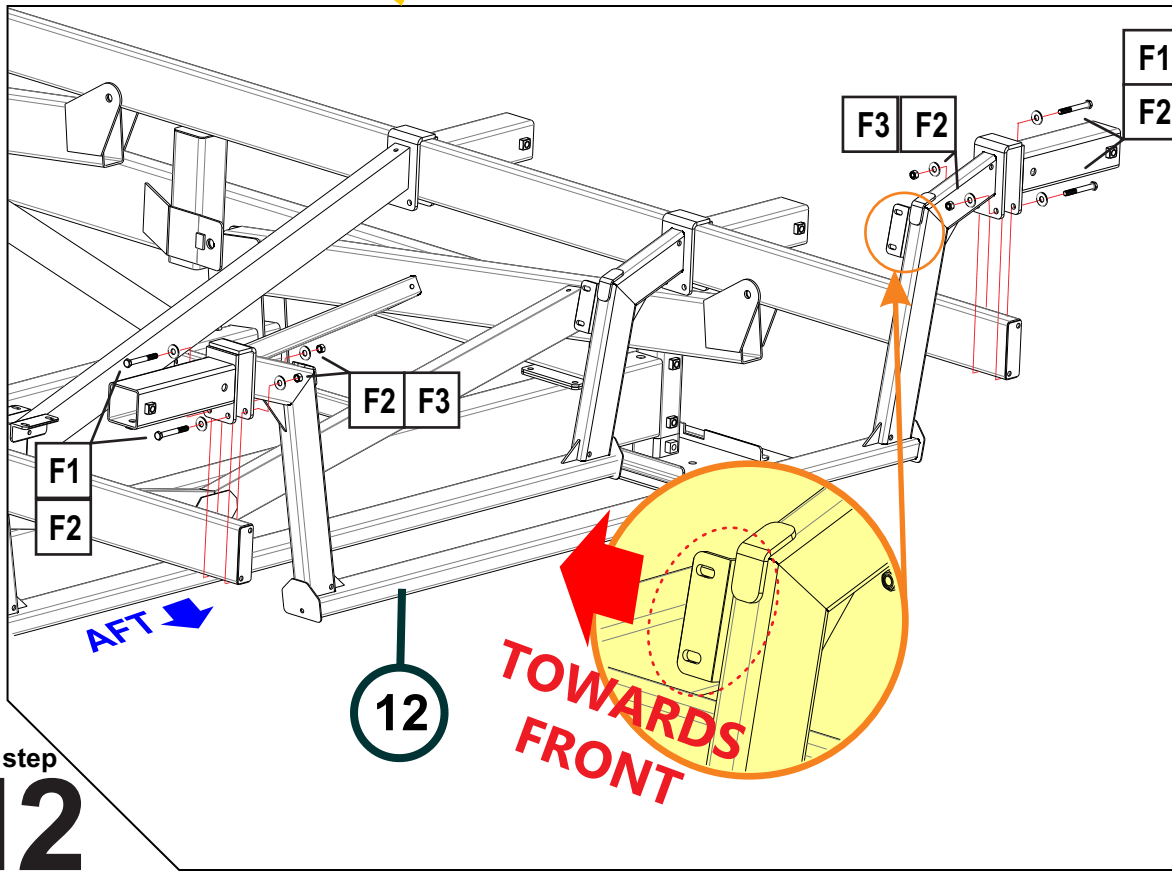

REF	TYPE	SIZE	QTY	HARDWARE
F1	bolts	1/2 x 4	4	apply a small amount of grease to bolt threads
F2	flat washers	1/2	8	
F3	lock nuts	1/2	4	

? parts identified on page 4

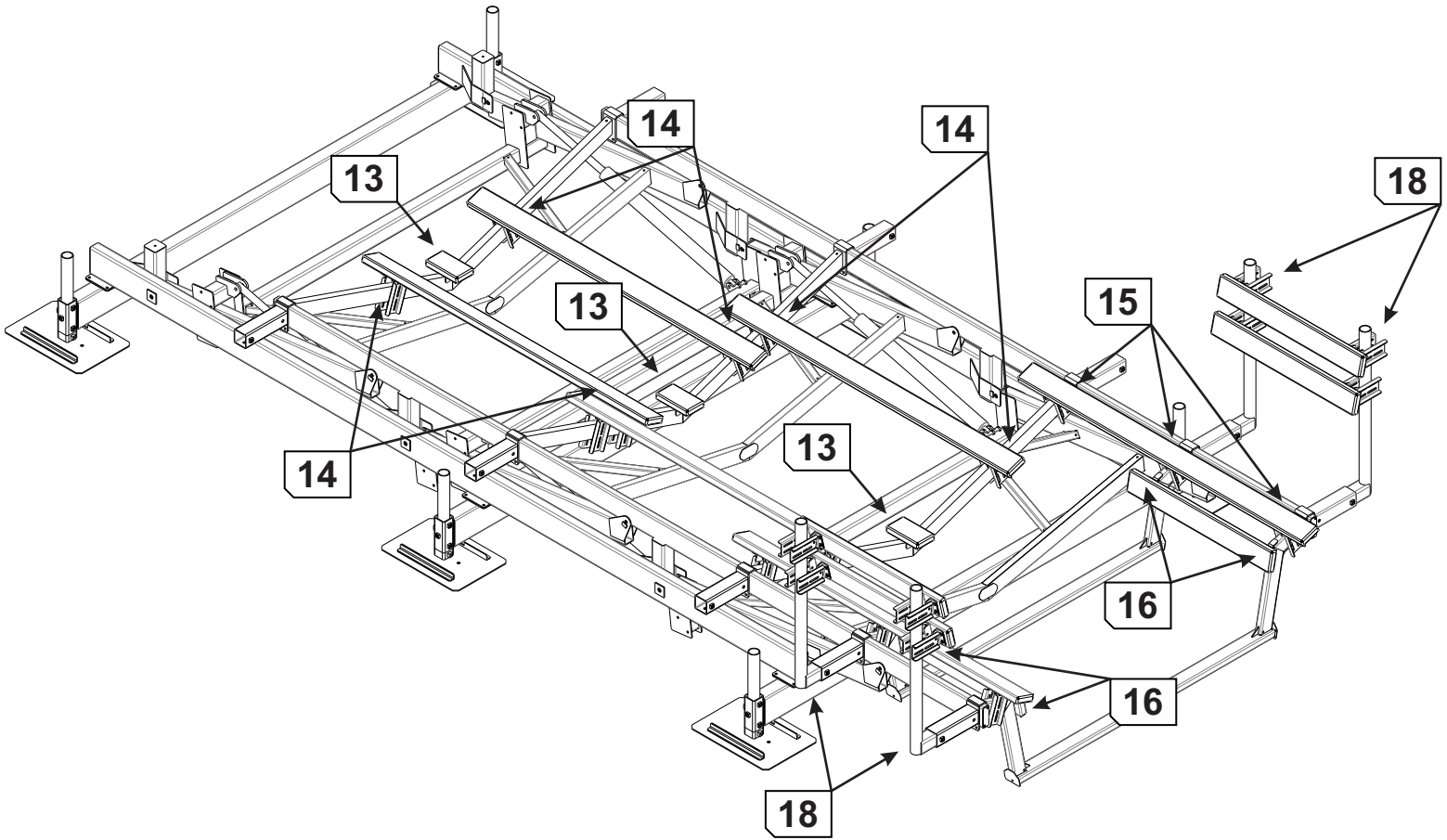

Keel Board (3 Total)

step
13

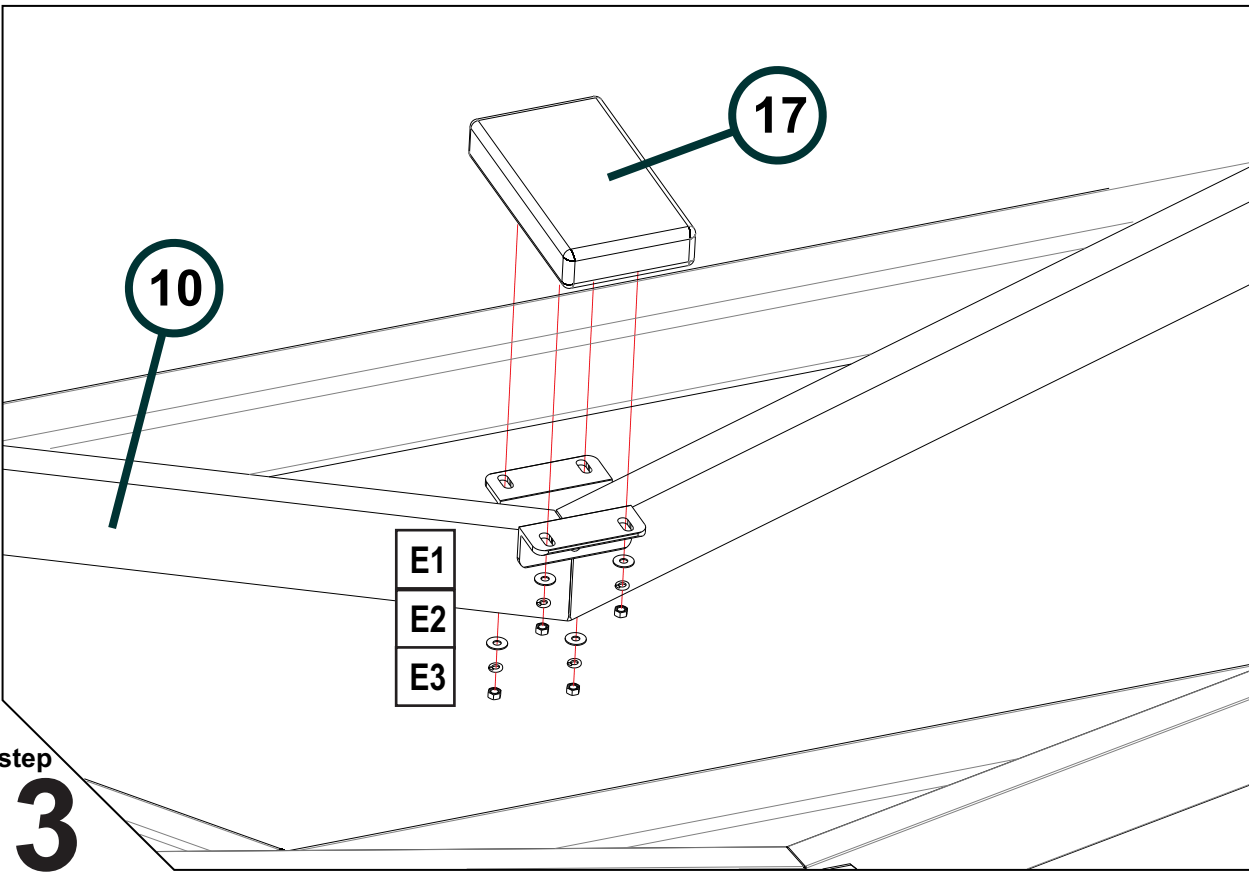

QTY	SIZE	TYPE	REF
12	5/16	galvanized flat washers	J1
12	5/16	galvanized lock washers	J2
12	5/16	galvanized nuts	J3
HARDWARE apply a small amount of grease to bolt threads			

Bunks FWD (4 total)

step
14

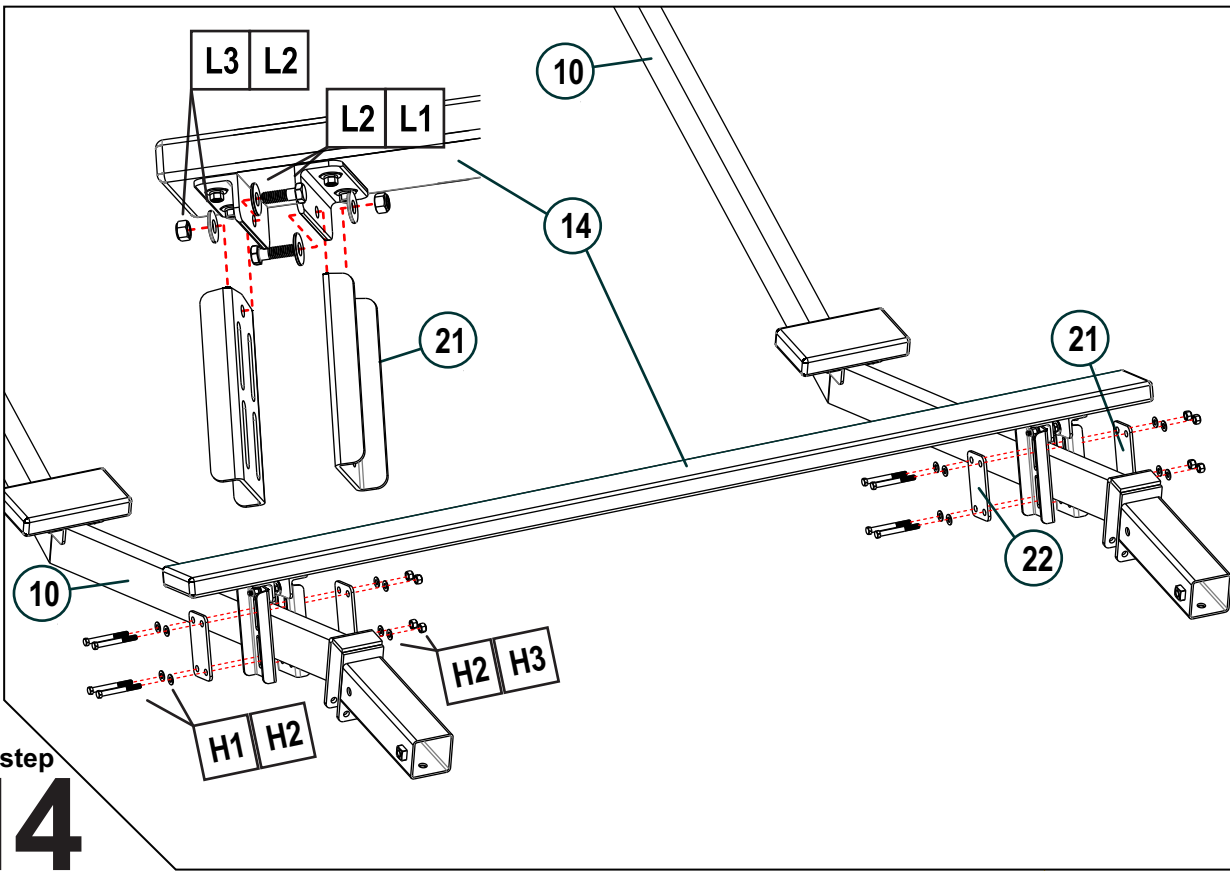

QTY	SIZE	TYPE	REF
32	1/2 x 4	bolts	H1
96	1/2	flat washers	L2, H2
48	1/2	lock nuts	L3, H3
16	1/2 x 1-1/2	bolts	L1

HARDWARE
apply a small amount of grease to bolt threads

NOTICE
remember to tighten all the bolts installed in Step 10

the bunks may have to be adjusted several times for the best fit - **WITHOUT BOAT ON LIFT!**

? parts identified on page 4

Bunks AFT (2 total)

step
15

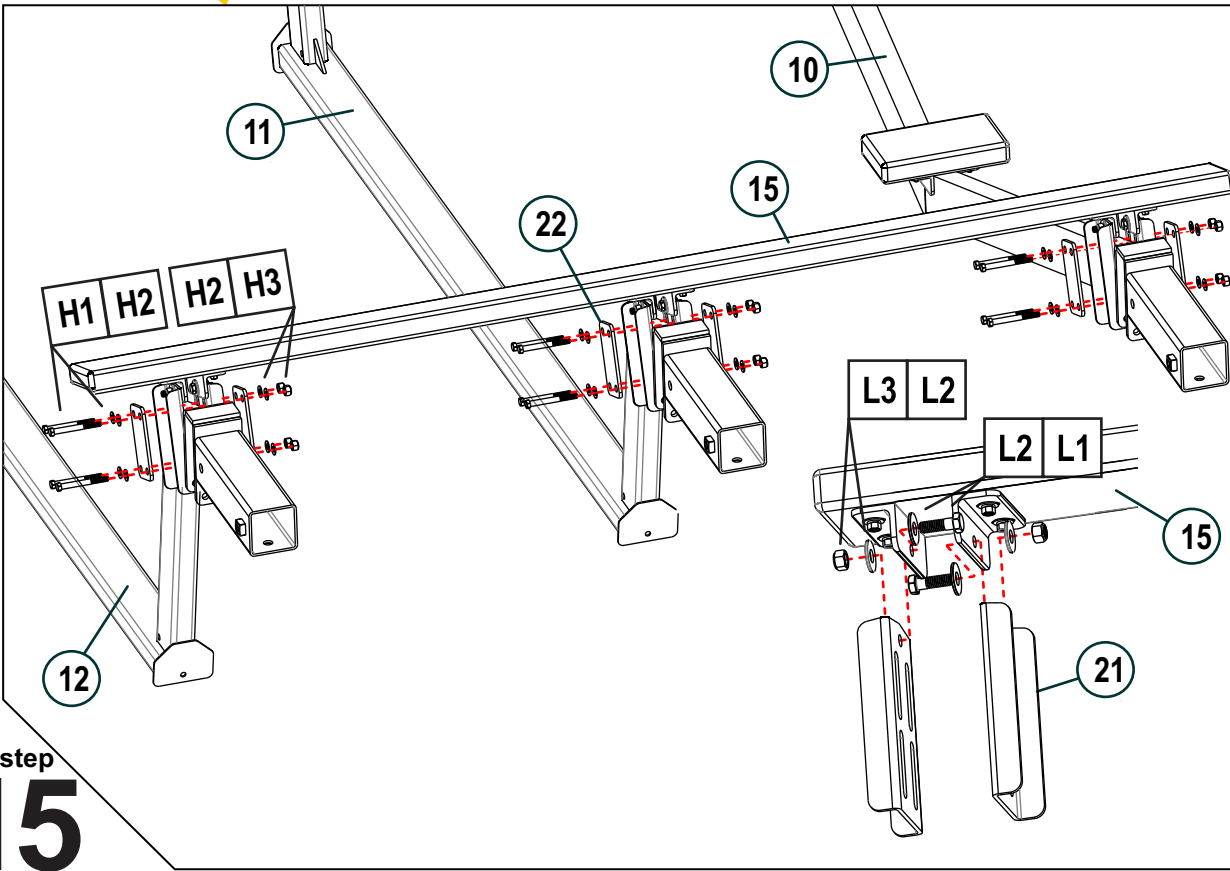

QTY	SIZE	TYPE	REF
24	1/2 x 4	bolts	H1
72	1/2	flat washers	L2, H2
36	1/2	lock nuts	L3, H3
12	1/2 x 1-1/2	bolts	L1

HARDWARE
apply a small amount of grease to bolt threads

? parts identified on page 4

Bunks (8 total)

step
16

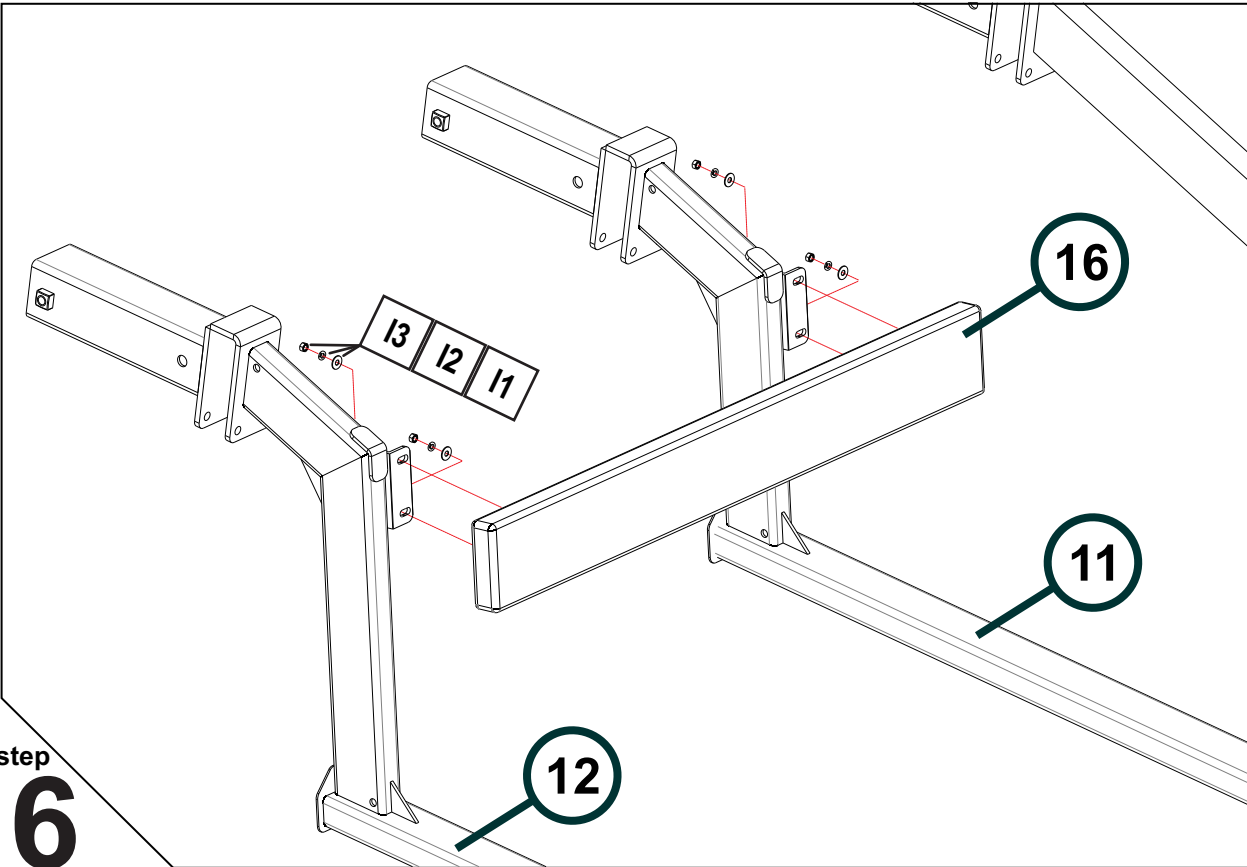

QTY	SIZE	TYPE	REF
8	5/16	galvanized flat washers	I1
8	5/16	galvanized lock washers	I2
8	5/16	galvanized hex nut	I3
HARDWARE apply a small amount of grease to bolt threads			

? parts identified on page 4

NOTE: pump appearance may vary

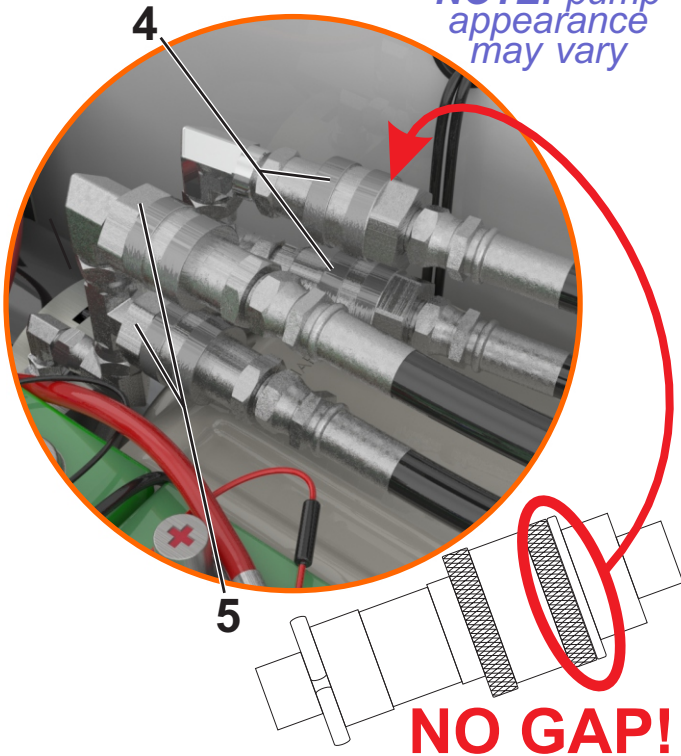

! Ensure each Quick Coupler is completely seated and *tight* with no gap at the connection joint. Connection must be *tight* to open internal check valve and allow fluid to flow. USE PLIERS

hydraulic fluid level with lift in DOWN position
only add fluid with lift in DOWN position

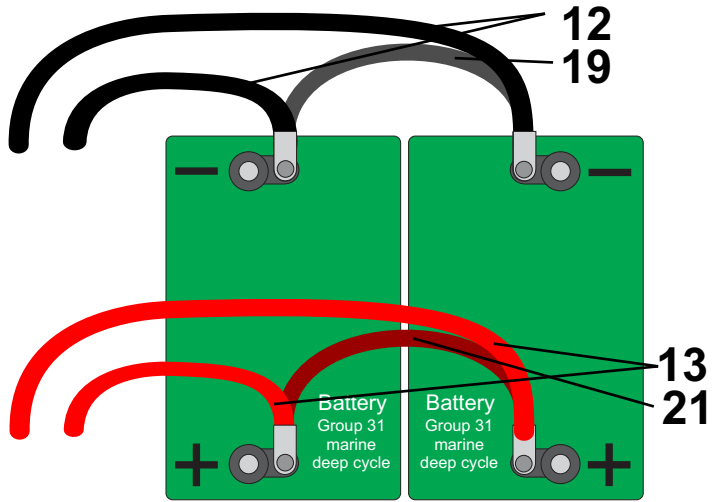
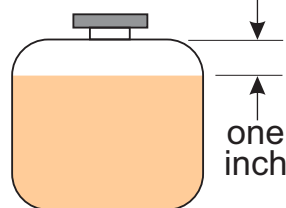

1. The Hydraulic Pump will arrive fully assembled. Make sure all the connections are snug to prevent leaks or loss of power to the unit.
2. Install two Group 31 Marine Grade Batteries as shown above. Confirm that the POWER switch on the Control Panel (#8) is OFF. Connect solar panel to the solar controller (see page 15).

Connect the Black Link Cable (#19) between the two negative terminals of the batteries. Connect the Red Link Cable (#21) between the two positive terminals of the batteries. Connect the Red Battery Cables (#13) to the positive terminals and the Black Battery Cables (#12) to the negative terminals of the battery bank as shown.

NOTE: Ensure battery cables are correctly connected and their terminals are very tight (otherwise there is a risk of overheating).

3. Slide the Hydraulic Cylinder Hoses through the access holes in the side of the White Fiberglass Box (#10) and attach them to their corresponding Quick Couplers (#4, #5).
4. Test the lift on dry ground using the Up/Down Switch (#9) and the Key Fob Transmitters. Inspect the system for leaks.

DO NOT

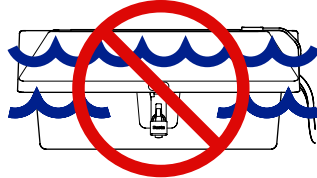

SUBMERGE POWER UNIT
Keep inside dry

! NOTICE

Tighten nuts on batteries very tight. Otherwise, cables may overheat during lift operation.

! WARNING

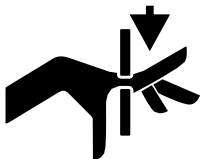

Power unit lid may close suddenly

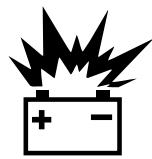

Battery produces flammable hydrogen



High pressure hydraulics can penetrate skin
OIL INJECTED INTO THE SKIN FROM HIGH PRESSURE LEAKS IN HYDRAULIC SYSTEMS CAN CAUSE SEVERE INJURY. MOST DAMAGE OCCURS DURING THE FIRST FEW HOURS. SEEK MEDICAL ATTENTION IMMEDIATELY. SURGICAL REMOVAL OF OIL MAY BE NECESSARY.

POWER SYSTEM COMPONENTS

NOTE: pump appearance may vary

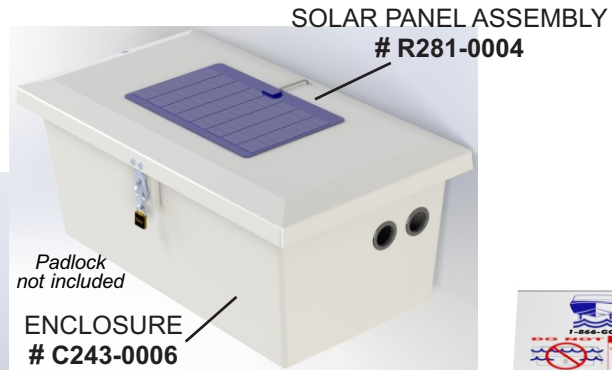
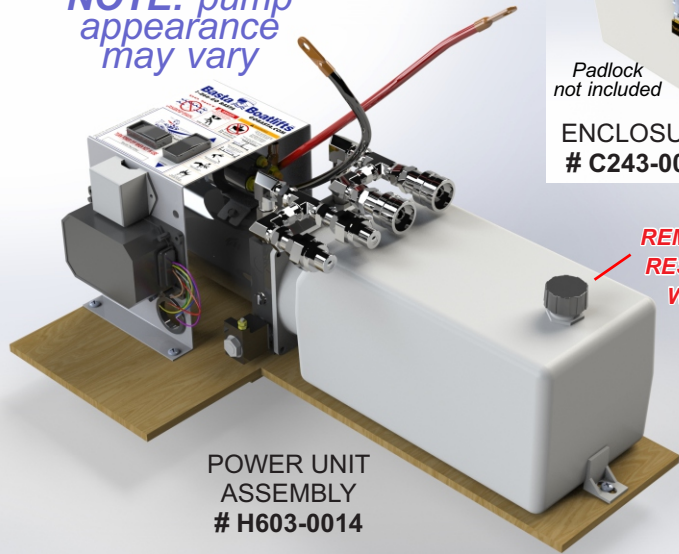

NOTE:
REMOVE SHIPPING PLUG IN
RESERVOIR AND REPLACE
WITH BREATHER PLUG
BEFORE START-UP

CONTROL PANEL
ASSEMBLY
R815-0008

*pre-wired
with wiring
harness*



Please order replacement parts by PART NO. and DESCRIPTION

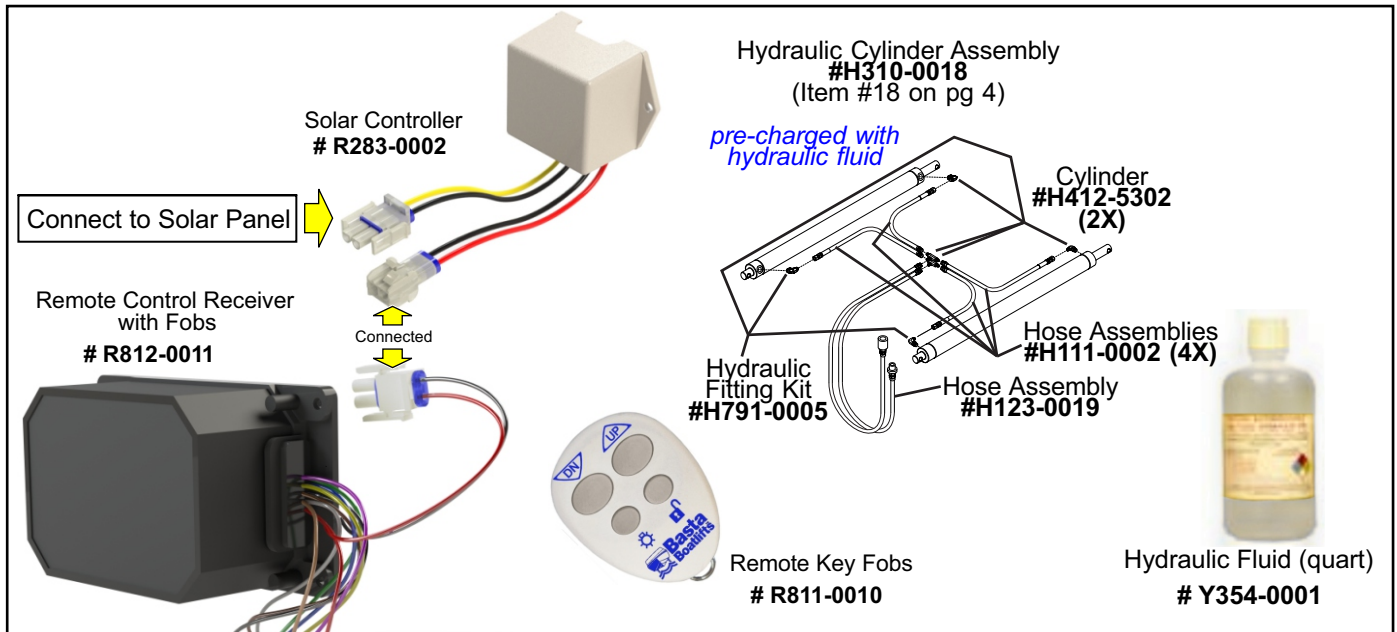

BATTERY SAFETY IS IMPORTANT

Follow all battery manufacturer's warnings
and safety information.

step 18

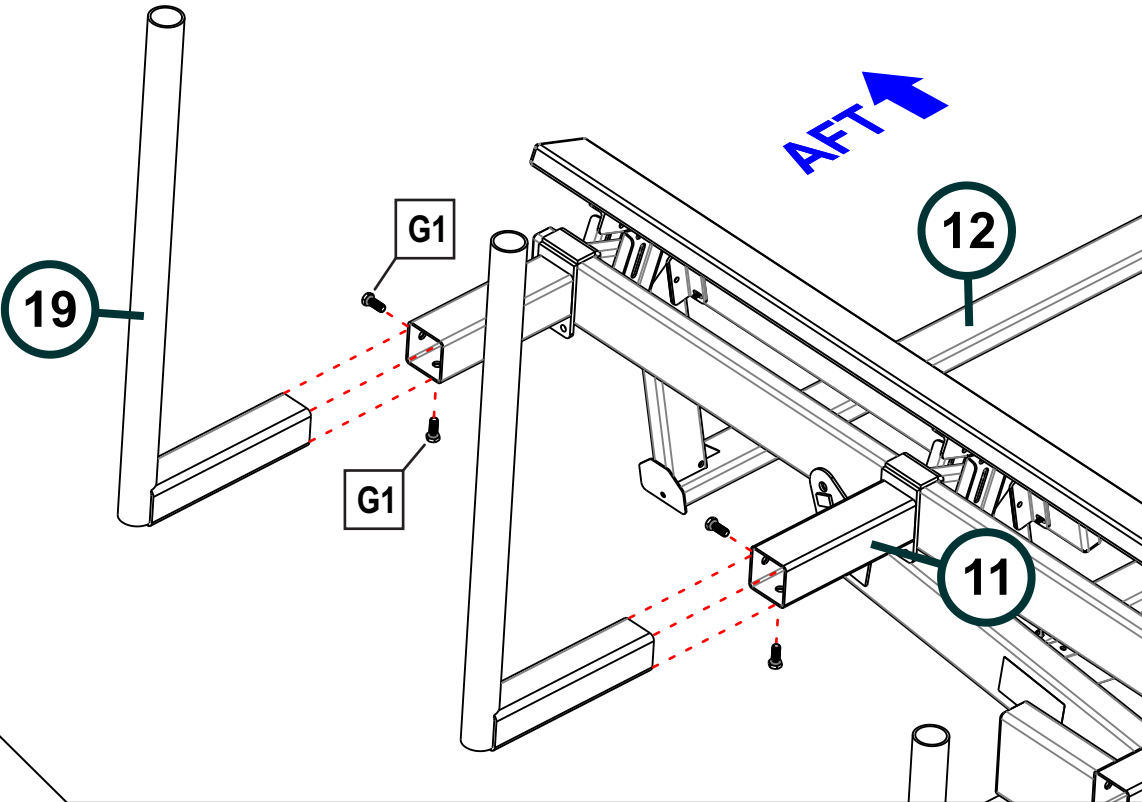

QTY	SIZE	TYPE	REF
8	5/8 x 1-1/2	hex head set screws	G1
HARDWARE			
apply a small amount of grease to bolt threads			

? parts identified on page 4

step 19

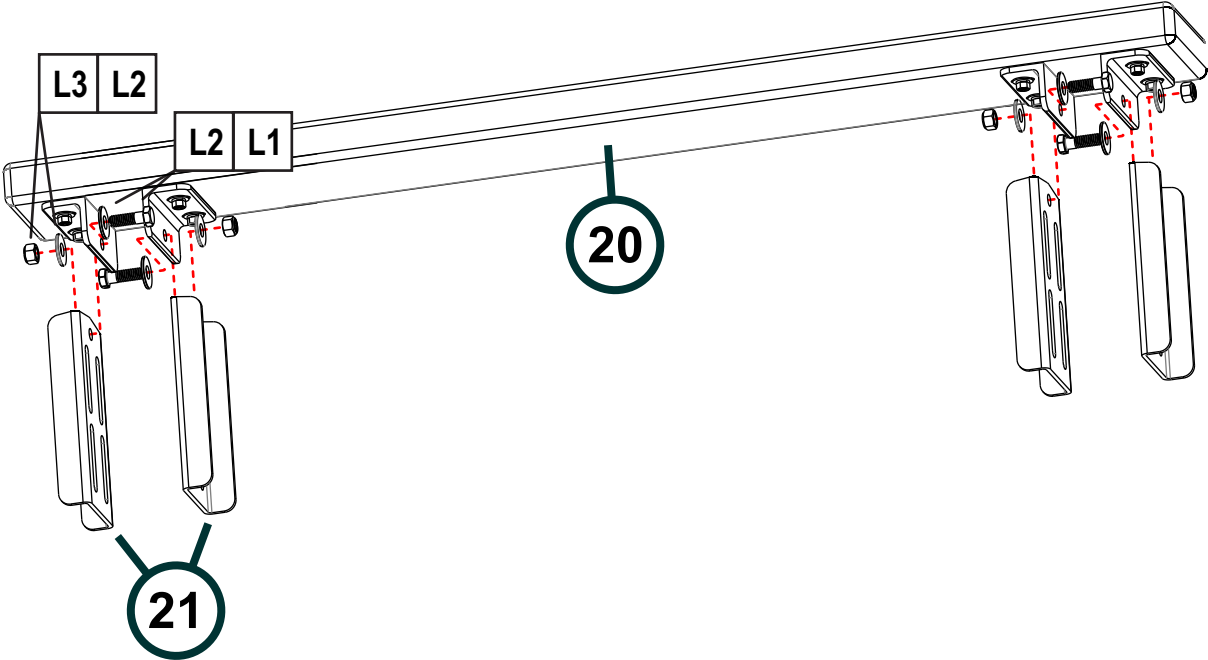

QTY	SIZE	TYPE	REF
16	1/2 x 1-1/2	bolts	L1
32	1/2	flat washers	L2
16	1/2	lock nuts	L3
HARDWARE			
apply a small amount of grease to bolt threads			

? parts identified on page 4

Guide Board Assembly, Upper

step
20

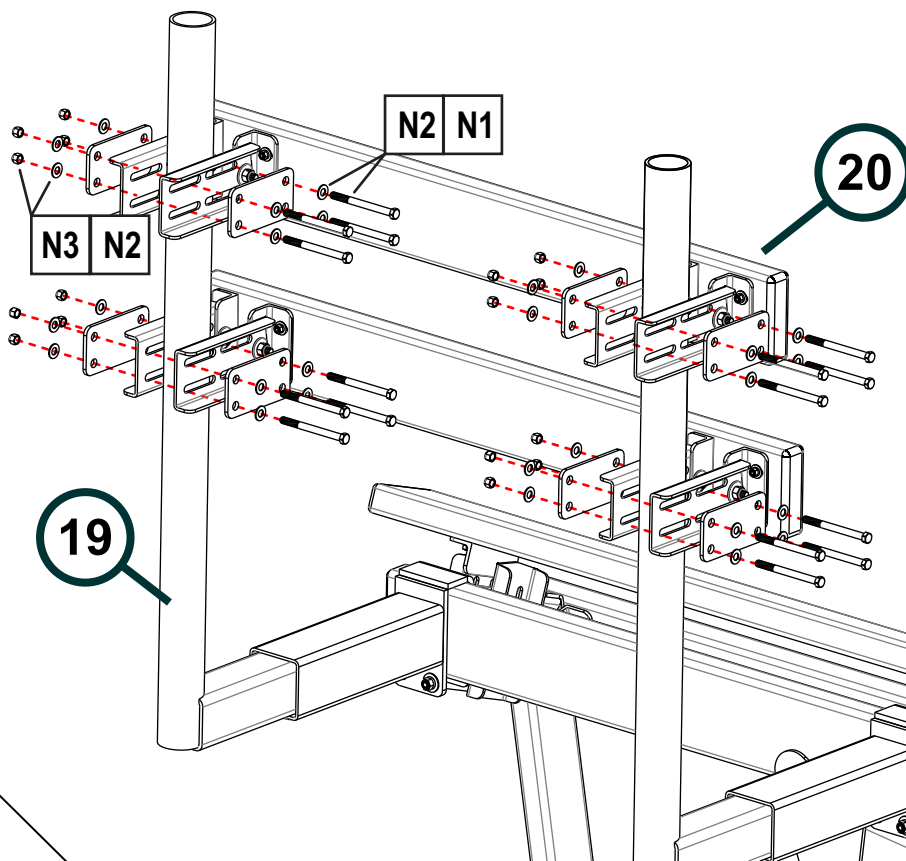

QTY	SIZE	TYPE	REF
32	1/2 x 5	bolts	N1
96	1/2	flat washers	N2
48	1/2	lock nuts	N3

HARDWARE
apply a small amount of grease to bolt threads

? parts identified on page 4

remember to tighten all the bolts installed in Step 10

note how bunk chevron fits *between* forward and aft bunk board stanchions

Centering Devices (total varies)

step
21

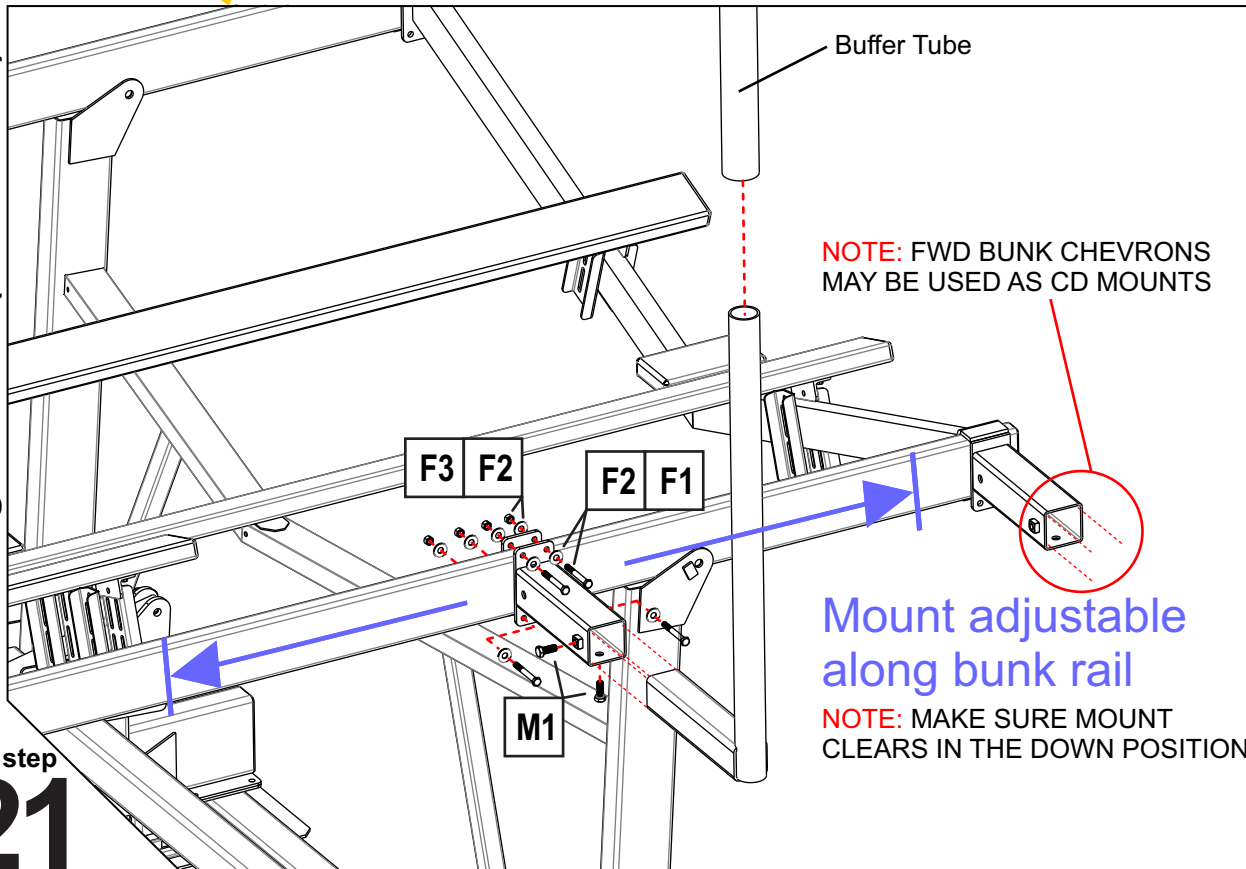

QTY	SIZE	TYPE	REF
X	5/8 x 1-1/2	hex head set screws	H1
X	1/2 x 4	bolts	F1
X	1/2	flat washers	F2
X	1/2	lock nuts	F3

HARDWARE
apply a small amount of grease to bolt threads

? parts identified on page 4

FIRST USE AND ADJUSTMENTS

First test lift on dry ground for oil leaks, remote control function and correct operation.

IMPORTANT: After installation, the legs MUST be adjusted so that the lift frame is level. Lift **must** move into Over-Center position when fully raised.

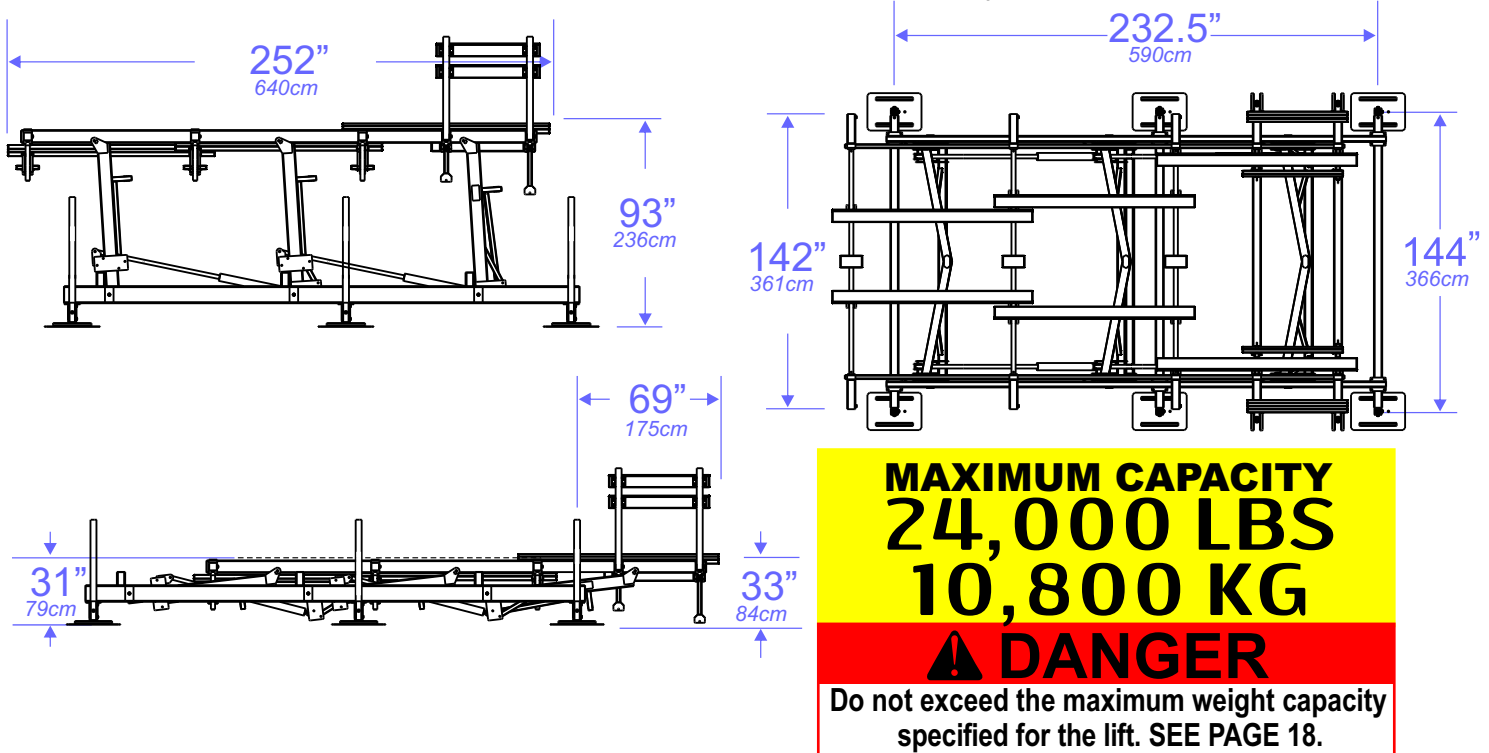

Follow this "first use section" during your first loading of a boat onto the boat lift. These are required adjustments to make the lift work correctly.

- Place the boat over the lift to the following specifications:
 - If your boat is an outboard, inboard/outboard, or V-drive, the transom should be 2 inches off of the ends of the bunk boards.
 - If your boat is a mid-engine or shaft-drive, the transom should be 12 to 24 inches off of the ends of the bunk boards.
- Disembark and raise the boat. If more than two inches of settling occurs, STOP, carefully lower the lift to remove the boat and re-level the lift. Continue repeating this step until the boatlift can be raised into the full Over - Center™ position without settling.
- Remove the boat. Verify that the lift frame is level. Re-level the framework if necessary.

NOTE: If you purchase a new boat, be sure it is within the weight capacity limits of the lift. Also remember that these adjustments will have to be done again to accommodate the new boat.

⚠ DANGER

Avoid all moving parts to prevent death or serious injury



STAY CLEAR!

Exceeding lift capacity may result in structural failure, injury or death

Failure to properly position boat on lift could cause lift to become unstable

⚠ WARNING

Always raise lift fully upright Over-Center (™) if boat is on lift unattended

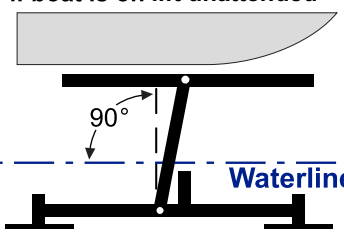

90°
Waterline

Before use always check that lift frame is level



Waterline

Do not use to lift humans

MAINTENANCE

Occasionally wipe the solar panel with a clean, damp cloth to preserve its charging performance.

⚠ WARNING

After the lift is assembled and installed, all fasteners should be checked for proper tightness and reinspected periodically.

⚠ NOTICE



INSPECT THE LIFT PERIODICALLY

Once a month:

Inspect the hoses, cylinders and fittings for leaks and wear.

Check the wire terminals for snugness and corrosion.

Check the hydraulic fluid level.

At least every 6 months:

Check the battery levels.

The battery electrolyte should be slightly above the indicator ring in each cell. Carefully add DISTILLED water if necessary

Do not over-fill.

⚠ WARNING



Battery produces flammable hydrogen

USE ONLY BASTA BIODEGRADABLE HYDRAULIC FLUID

We recommend Chevron Clarity® AW ISO 32 or CITGO Aquamarine® 46 hydraulic oils.

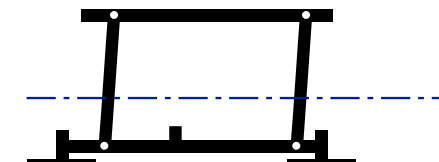
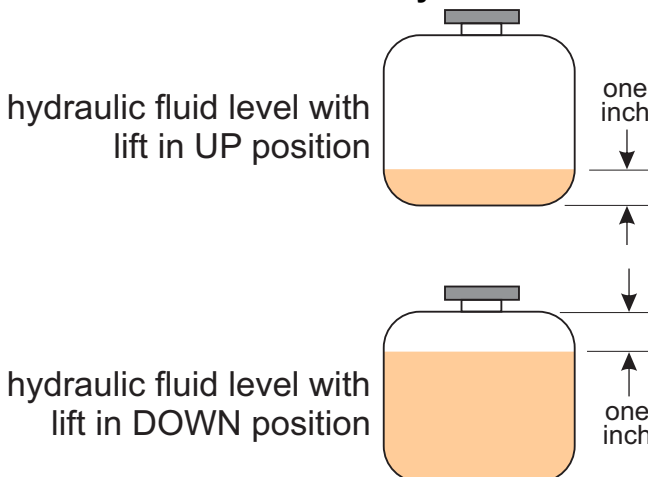

DO NOT add fluid with lift in RAISED position

add fluid ONLY with lift in LOWERED position



TROUBLESHOOTING PROBLEMS AND FAQ

Q: HOW DOES THE REMOTE CONTROL WORK?

POWER-UP

At power-up the remote fob function has a ten second delay. Failure to wait for this ten seconds can make the wait time much longer.

LIFT OPERATION

The remote fob is non-functional until it is enabled by depressing the lower right unlock button momentarily. After the initial ten second delay, depressing the unlock button enables operation using the remote fob. **The lockout is re-enabled after 60 seconds without a button press.**

Lift operation using the fob is limited to 120 seconds of continuous operation. If a longer cycle is needed it is necessary to release and then re-depress the button.

LOW BATTERY LOCKOUT

This control incorporates a low voltage lockout which is intended to protect the battery from abuse and over-discharge. When the battery drops below the low battery threshold during pump operation, further activation using the Fob is not allowed. The battery needs to be checked prior to further operation. The manual switches will allow the lift to operate if sufficient battery power is present.

FOB PROGRAMMING

At initial power up there is a five second window when it is possible to reprogram the receiver to enroll a remote fob. Up to four fobs may be enrolled. If a fifth fob is enrolled, the first enrolled fob will fall off the list.

To enroll a fob, turn off the power to the lift for fifteen or more seconds. When power is turned back on press both the UP and DOWN buttons on the fob simultaneously. This must be done within the first five seconds after power is applied.

LIGHTING CIRCUIT

The lighting circuit is activated whenever the lift is operated. The lights stay on for 2 minutes after the lift is operated

The lights may be manually turned on or off by depressing the lower left button on the remote Fob. When manually enabled the lights will automatically turn off after 4 minutes. This prevents accidental battery discharge.

STORAGE

Always leave the boat in the fully raised, Over-Center™ position with the power off.

Q: THE BATTERY WILL NOT HOLD A CHARGE

- A:** Verify that the loaded boat is not exceeding the weight capacity of the lift. If the battery is a flooded-cell type, check the electrolyte level.
- A:** Ensure the solar panel is properly connected.
- A:** Re-align the solar panel for proper exposure to the sun.
- A:** Recharge the battery with a 10 amp charger and check the charge again.
- A:** Have the battery tested. It may be old and require replacement.
- A:** If the lift is being used frequently during the day, it may be necessary to use a 110-volt maintainer/charger.

Q: THE REMOTE CONTROL IS NOT FUNCTIONING

- A:** The battery in the key fob transmitter may be low. Replace it with a new lithium CR2032. These are widely available at variety, hardware and even grocery stores. Polarity is marked on the battery holder.
- A:** Verify that the power unit battery is charged and connections are tight.
- A:** Reprogram the remote key fobs.

Q: THE PUMP DOESN'T RUN

- A:** Check the battery charge and recharge if necessary.
- A:** Check the battery connections, clean and re-secure if necessary.

Q: THE PUMP RUNS, BUT THE LIFT DOESN'T MOVE

- A:** Check the 'quick couplers' in the Power Unit. If they are not screwed together tight enough, built-in check valves will not allow fluid to flow. See Page 12.
- A:** Check the fluid level. See Page 12.

Q: DOES THE LIFT HAVE TO GO ALL THE WAY UP?

- A:** YES - in order for your lift to function as intended the lift must ALWAYS be stored in the full upright position when the boat is unattended.

Q: IS MY BOAT SECURE?

- A:** Yes, once you verify that the lift is Over-Center™, switch off the power and lock the power unit box, there is less chance of theft.

Q: DO I NEED A MOORING LINE?

- A:** Under most circumstances one mooring line is sufficient to prevent the boat from drifting away if the lift is inadvertently lowered or the water level rises.

Q: HOW MUCH SUN DOES THE SOLAR PANEL NEED?

- A:** The panel should receive constant sun for at least 8 hours a day.

Q: HOW DO I CHANGE THE HYDRAULIC FLUID?

- A:** Our fluid should not require replacement for a considerable amount of time. If yours has been contaminated or the hydraulic power unit has been replaced, visit our web site at www.gobasta.com for detailed instructions.

Q: IS THE HYDRAULIC FLUID SAFE FOR THE FISH?

- A:** We use a special low-toxicity hydraulic fluid that is safe for the environment. This fluid is different than food-grade oil. Only use Basta Boatlifts approved fluid in your hydraulic system.

Q: WHAT IF I GET A NEW BOAT?

- A:** Re-leveling the boat lift may be necessary. A new lift will be required if the boat exceeds the weight capacity of your current lift.

FOR ASSISTANCE OR SERVICE:

Contact your local dealer or call 1 - 866 - GO - BASTA
website: www.gobasta.com email: info@gobasta.com

A fully automatic battery charger or trickle charger may be used.

**Do NOT use a high power manual or boost charger unless the battery is disconnected!
The remote control electronics may be damaged.**

WARNING

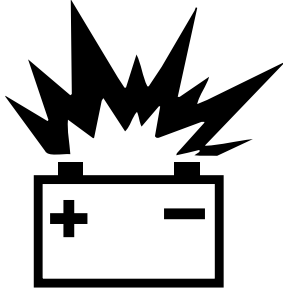

**Battery produces
flammable hydrogen**

1. This lift uses two 12V Group 31 marine deep-cycle batteries. When looking for a replacement, note that the figure for Reserve Capacity is the most important feature. Heavier batteries usually have more reserve capacity.

2. The batteries should not be allowed to remain in a substantially discharged state. It may result in permanent loss of capacity. Do not deeply discharge batteries more often than absolutely necessary; it may reduce the life of the batteries.

3. The following graph shows the approximate numbers of complete lift cycles that may be expected during the day over the course of the seasons while keeping the battery adequately charged. This data is only very approximate and is influenced greatly by weather, temperature, solar panel placement and cleanliness.

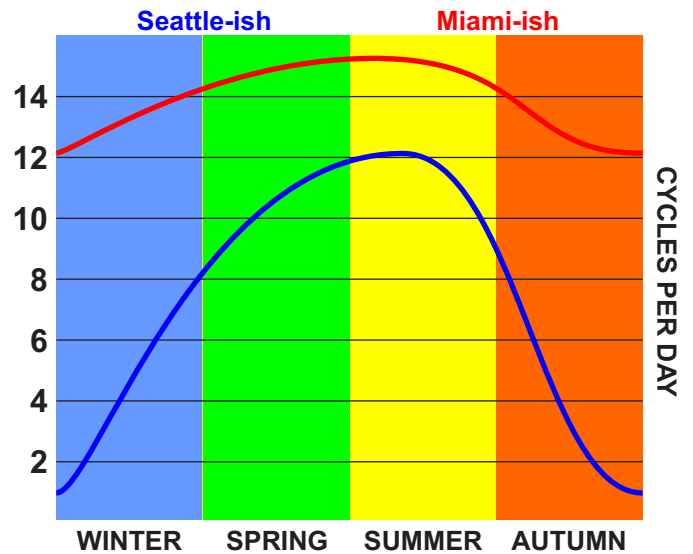

WARNING

Your boat lift is a piece of heavy power equipment that lifts a load that weighs thousands of pounds. Failure to comply with the following rules may result in severe injury, death or property damage.

1. Be alert and aware at all times. Do not operate while under the influence of drugs or alcohol.
2. Children should not operate the lift without adult supervision.
3. No one should operate the lift without knowledge of safe operating procedures.
4. NEVER exceed the specified capacity of the lift. Someone may be injured or killed.
5. Position the boat properly on the lift. Improper placement may cause dangerous instability or failure.
6. Do not operate the lift with people in the boat. Load and unload passengers only when boat is floating, lightly touching the bunks.
7. No one should play on or swim near the lift.
8. Whenever your boat is left unattended on the lift, make sure it is raised into the over-center position. Otherwise, unintended motion may occur.
9. Be sure the lift frame remains level. If the lift has settled unevenly, it may be unstable and dangerous when loaded. All four corners must be level within 2 inches.
10. NEVER go under your boat when it is on the lift
11. Do not perform major maintenance operations on your boat when it is on the lift. The boat may shift and injure or kill you. Haul the boat out to perform maintenance.
12. Do not leave things in the hydraulic power unit. They could cause damage to the pump or electrical system or catch fire.
13. Your lift may be hidden under water when your boat is gone. Notify any potential divers in the area of its location to prevent accidents.
14. Do not power your boat hard onto the lift. Lower the lift so your boat glides into position. The lift may be moved or damaged if you attempt to load with insufficient water depth
15. The lift must be thoroughly inspected regularly for overall condition, leaks and corrosion.

Basta Boatlifts Limited Warranty



**Basta
Boatlifts**

Thank you for investing in one of the finest PWC lifts in the world. We pride ourselves in knowing our product will safely and reliably be the conduit to your fun on the water. Welcome to the Basta Boatlifts family and Boat Happy!

Basta Inc. dba Basta Boatlifts ("Company") warrants its Products (purchased after November 1st, 2021) for non-commercial use for a period of,

- 16 years against manufacturing defects in steel and aluminum lift frame welds.
- 3 years against defects in materials and workmanship including hydraulic components, charging system, remote controls, dock box, bunks, canopies, and accessories.
- 1 year battery warranty when maintained in accordance with battery manufacturer's guidance for batteries supplied by the Company,

to the original Purchaser ("Purchaser"), beginning from date of purchase of the Product from Company. If the Product is purchased from an authorized Company Reseller, the warranty term begins upon the date the new Product is sold to the end Purchaser ("Warranty Start Date").

Annual inspection of the Product bolts, pins, hydraulics, pump, electronics, and welds, by a Company employee or Company authorized agent, shall be conducted. Failure to undertake such maintenance shall constitute "abuse" under Exclusions below.

Company has the right to modify Products at any time without incurring any obligation to make the same or similar modifications on Products previously manufactured or purchased.

Terms And Conditions:

Purchaser must register Product for a valid Warranty. Warranty registration may be found and submitted at:

<https://bastaboatlifts.com/support>.

Notice requirements and remedies:

If the Purchaser discovers a defect, the purchaser shall immediately notify the Company in writing by submission of a Warranty Claim form. Warranty Claim forms may be found and submitted at <https://bastaboatlifts.com/support>. Upon receipt of a complete Warranty Claim form and after confirmation by Company that the Product is defective, the Company, or its authorized Company dealer or agent, will, at the Company's sole discretion:

- 1- repair the Product or,
- 2-replace the defective part with a new or reconditioned part, or
- 3-refund the purchase price of the Product.

Confirmation of the defect shall require that reasonable proof of the defect be provided by Purchaser to Company or Company authorized agent, and may include that the Product or part be returned to Company for inspection at the Purchaser's initial expense. If the Purchaser chooses to order a replacement part prior to the final determination of the warranty claim, Purchaser will be responsible for the cost of the replacement part and its shipping. If the part is determined to be a valid warranty claim, the customer will be credited the amount of the replacement part and its shipping. Replacement parts for Products outside the United States will be shipped in the next authorized Dealer shipment unless

Purchaser agrees to pay for door to door freight of warranted Product. Warranty replacement shall not extend the original warranty of the defective Products.

Labor for warranty work to be provided by the Company's Authorized dealer for a period of 3 years from Warranty Start Date, provided there is an active Authorized Dealer within 50 miles of the location of the Product. Labor will not be provided for direct purchases from Company or when an active Authorized Dealer is not located within 50 miles of the location of the Product.

Warranty requests received after expiration of warranty term will not be covered under this warranty regardless of when the defect occurred or was discovered.

Confirmation of the defect shall require that reasonable proof of the defect be provided by Purchaser to Company or Company authorized agent, and may include that the Product or part be Returned to Company for inspection at the Purchaser's initial expense. Replacement parts for Products outside the United States will be shipped in the next authorized Dealer shipment unless Purchaser agrees to pay for door to door freight of warranted Product. Warranty replacement shall not extend the original warranty of the defective Products.

Labor for warranty work to be provided by the Company's Authorized dealer for a period of 3 years from Warranty Start Date, provided there is an active Authorized Dealer within 50 miles of the location of the Product. Labor will not be provided for direct purchases from Company or when an active Authorized Dealer is not located within 50 miles of the location of the Product.

Warranty requests received after expiration of warranty term will not be covered under this warranty regardless of when the defect occurred or was discovered.

Exclusions:

Product changes caused by age or environment (such as marine growth, heat, corrosion or electrolysis) shall not constitute a defect. In addition, this warranty does not cover or apply to the following: damages caused by or due to without limitation: accidents, collision, fire, flood, wind, ice, or any other natural disaster or acts of God, abuse, misuse, overloading, improper watercraft loading, use when out of level, faulty assembly or installation. Lift components' fluid levels and condition, including battery electrolyte (water and acid), hydraulic fluid and strainer cleaning are maintenance items and are not covered by this warranty. Sacrificial anodes (zincs), cosmetic concerns and custom coatings are not covered by this warranty.

Warranty is void if the Product has been modified in any way or if any Company serial number has been removed or defaced. Product purchased from Company, but used on non-Company Products are excluded from this warranty.

Limitations:

To the maximum extent permitted by law except as expressly stated herein, there are no warranties, expressed or implied, by operation of law or otherwise, of the Product furnished under this Agreement. Seller disclaims any implied warranty of merchantability or fitness for a particular purpose. The sole remedy for liability of any kind shall be limited to the remedies provided in this warranty and shall in no event include any incidental, indirect, special or consequential damages or loss of use, revenue or profit. Should the company nevertheless be found liable for any damages, the total liability of the company shall be limited to the purchase price of the Product.

ACCESSORIES FOR MOST BASTA BOATLIFTS™

For additional information and images visit our web site at www.gobasta.com or contact Basta Marine at 1-866-GOBASTA for a catalog.



Centering Devices

These vertical reference guides gently center your boat over the lift and provide a constant reference point for front/back positioning.



Power Unit Support Bracket

Safely secure the power unit box to a boatlift canopy leg or the side of your dock.



Bow Stop

This adjustable bow stop assists in proper placement of your boat by gently stopping its forward motion.



Light kit

Install these lights above or below the water. They turn on with your remote control key fob.

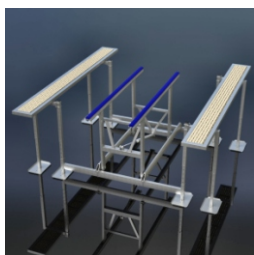

Side Deck Brackets

One of the many advantages of using a boat lift is the increased accessibility to your boat for maintenance. These brackets allow a side deck to be attached to the existing boat lift or canopy legs.



Load Guides

Designed to make loading your boat straight and true amazingly easy - even in cross winds and active water.

CANOPIES

Protect your boat from the harmful effects of the sun, wind and snow.

Solø™ 33 canopy



Basta Solø™ canopy features:

- Low profile silhouette
- Sturdy and wind resistant
- Attaches to a variety of lifts
- Wide choice of colors
- Durable Weblon® vinyl top
- Optional Sunbrella® tops
- 22, 24, 26, 30, 33, 39 foot lengths
- 10 and 12 foot widths
- All aluminum design
- Custom extrusions - no welds



Basta, Inc.

Bellevue WA 98005 USA